

- 18 - At the bottom end of the wand, fix the clear plastic floor cleaning head. For hard floors, clip squeeze attachment to the floor cleaning head.
- 19 - Fix the solution hose with the special clips to the wand.
- 20 - Activate suction by pressing the red switch, after having connected the machine to the power socket.
- 21-22 - Typical examples of wet vacuuming.

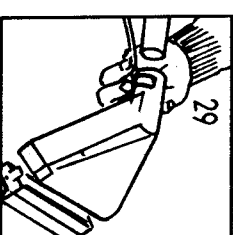
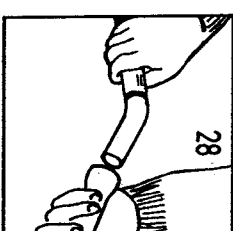
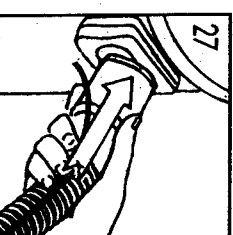
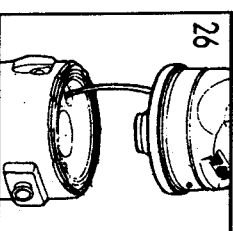
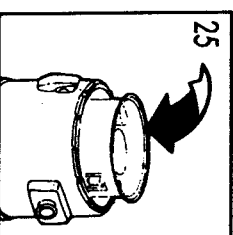
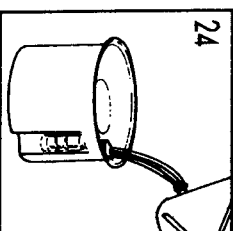
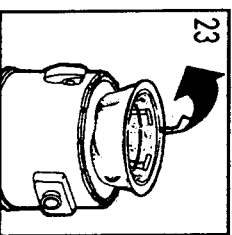
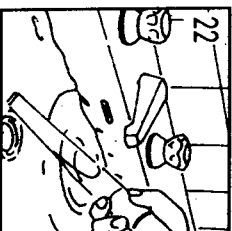
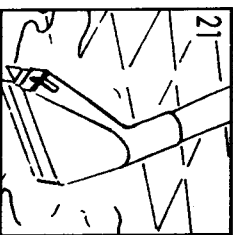
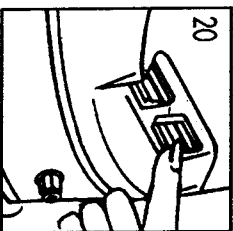
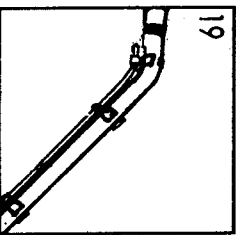
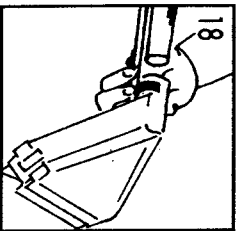

- 26 - Place the motor head on the tank, ensuring the chemical solution tube is placed in the smaller opening leading to the clean water tank. Clip the motor head into place.
- 27 - Fix the flexible hose into the suction inlet.
- 28 - Fix at the end of the flexible hose, the wand, the extension and the top bend.
- 29 - At the bottom end of the wand, fix the clear plastic floor cleaning head. For hard floors, clip squeeze attachment to the floor cleaning head.

FLORIDA/ATLANTA POWER BRUSH HEAD

These powerful brush heads are designed to be used with your **California** Extractor System to provide a universal floor care system. The unique high speed cylindrical brush action enables carpet, Rubber, marble, linoleum and parquet floors to be thoroughly cleaned.

OPERATION

Assemble California Extractor following the same procedure as for carpet cleaning substituting the Atlanta or Florida power brush (N) for the carpet tool (D).

Attach the Florida/Atlanta power cord into the power socket located on head (A), the power brush will operate when the suction motor is switched on.

Select area to be cleaned, switch on suction motor and pump, push power brush forward while depressing trigger valve, at completion of forward stroke, release detergent valve and tilt the Florida/Atlanta head forward to bring brush into contact with the surface and draw power brush towards you while moving backwards. Repeat procedure over total surface area that is to be cleaned.

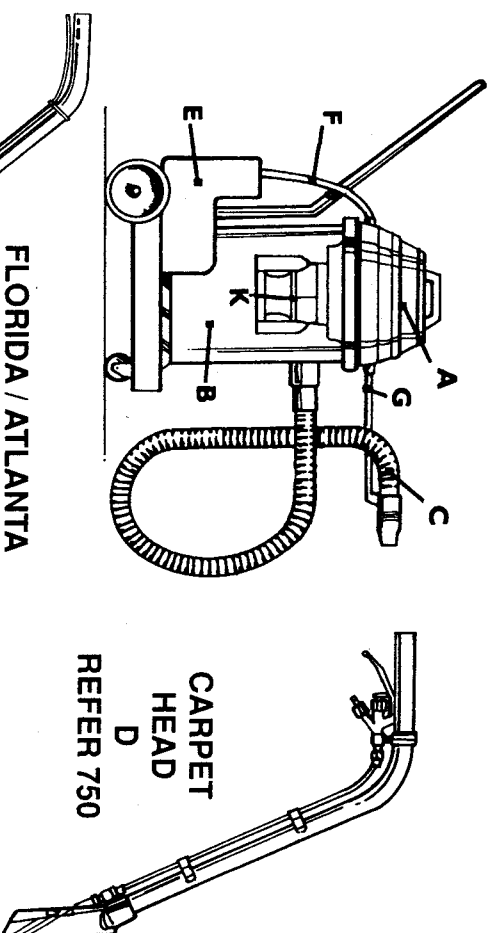

ASSEMBLY DETAILS

CARPET/UPHOLSTERY CLEANING

- C - Motor head
- D - Clean water tank with liquids-float
- E - Main tank
- F - Suction inlet
- G - Flexible vacuum hose
- H - Injection fluid hose
- I - Upholstery tool
- K - Fluid control trigger
- M - Extension wand
- N - Fluid hose
- O - Bottom wand
- P - Top wand
- Q - Carpet tool
- R - Squeeze head
- Y - Fluid pick-up tube
- V - Crevis nozzle

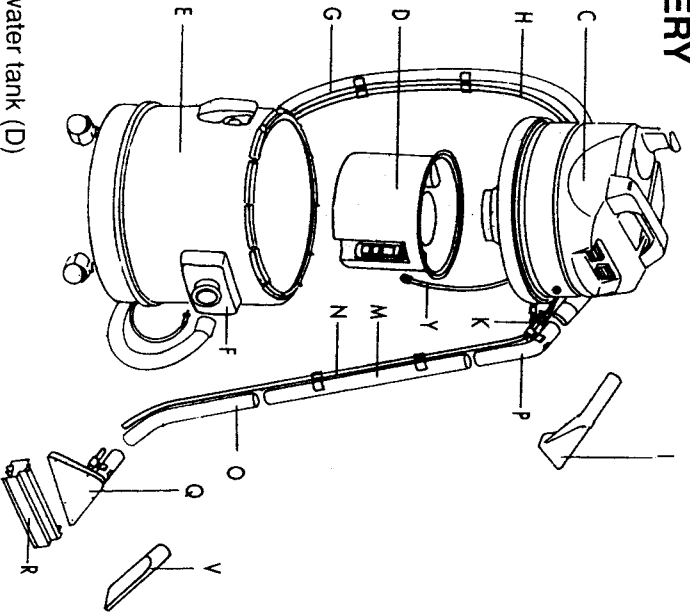

Note - Model ZIP has its clean water tank (D) located on the outside of main tank (E)

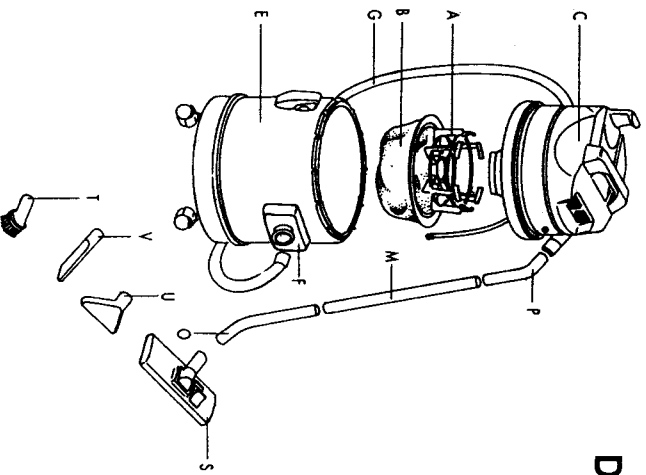

DRY VACUUM CLEANING

- A - Filter stretching basket
- B - Cloth filter
- C - Motor head
- E - Main tank
- F - Suction Inlet
- G - Flexible vacuum hose
- M - Extension wand
- O - Bottom wand
- P - Top wand
- S - Floor tool
- T - Brush
- U - Stair & upholstery nozzle
- V - Crevis nozzle

TROUBLE SHOOTING

| PROBLEM | PROBABLE CAUSE | SOLUTION |
|---------------------------------|--|---|
| No fluid in the nozzle | <ol style="list-style-type: none"> 1. Detergent tank empty 2. Nozzle blocked 3. Strainer in tank blocked 4. Pump not operating 5. Motor faulty 6. Pump not operating because valves are dirty or stuck 7. Pump faulty 8. Pump overloaded/ thermostat has dripped | <p>Fill</p> <p>Clean</p> <p>Clean</p> <p>Insert plug, switch on at motor switch</p> <p>Replace</p> <p>Remove strainer in detergent tank and flush out pump with clean water</p> <p>Replace</p> <p>Investigate cause, wait for pump to cool down</p> |
| Irregular spray pattern | Nozzle blocked or worn | Clean or replace |
| Insufficient operating pressure | <ol style="list-style-type: none"> 1. Wrong or worn nozzle 2. Detergent tank empty | <p>Fit new nozzle</p> <p>Fill tank</p> |
| Insufficient Vacuum | <ol style="list-style-type: none"> 1. Tank full, float blocking motor inlet 2. Filter in centre of detergent tank, clogged 3. Motor faulty | <p>Empty tank</p> <p>Clean</p> <p>Replace</p> |
| Float closes off | <ol style="list-style-type: none"> 1. Waste water tank is full 2. Excessive foaming in waste water tank - floor has concentration in tank possibly been shampooed before | <p>Empty waste water tank</p> <p>Reduce detergent</p> |

INTRODUCTION

Your new KERRICK Upholstery/Carpet cleaning machine is a wise investment. As a result of product development this equipment has quality, durability and consistency built into it, and properly treated will give many years of service.

You will get the best use from your KERRICK machine if you follow the suggestions for maintenance contained within. Please read the user instructions and familiarise yourself with the features and operating details. If you have any special questions, write or phone us or contact your selling dealer and we will be glad to help you. To avoid any delay in assisting you, please always quote the machine model and serial number.

WARNING!

IMPORTANT SAFE GUARDS

Read these instructions carefully and keep them for reference purposes.

The packaging around the cleaner (plastic bags, clips, etc.) are potentially dangerous objects and should be kept out of reach of children and others not accountable for their own actions.

Once the cleaner has been taken out of the packaging, check that it is complete. If any doubt arises as to this point the cleaner should not be put into use, but you should contact your selling dealer IMMEDIATELY.

CAUTION!

- Prior to connecting the cleaner check that the specified mains voltage (see model plate) corresponds to the voltage available.
- The cleaner should only be used for the specified purposes, viz, wet, and dry cleaning of carpet and upholstery. Using the cleaner for other purposes is both incorrect and hazardous.
- When the cleaner has been connected and running, the attachment should not come close to sensitive sections of the body, such as eyes, mouth, ears, etc.- The cleaner should never be left unattended in the presence of children or other persons not accountable for their own actions.
- When the cleaner is not in operation remember to switch it off.
- The cleaner should never be lifted by the electric cable, or be unplugged by pulling the cable.
- Check the cables prior to use. A Machine with a defective cable should never be used.
- When using extension cable connections they should be kept dry and away from any moist surfaces.



WARRANTY

Kerrick Group of Companies warrants it's commercial & professional products against defects in material and workmanship for a period of 12 months from the date of original purchase by the first purchaser as shown on the warranty registration card supplied with the product.

Domestic models (eg) Lava, are also warranted for a period of 12 months when used for domestic purposes. Where domestic models are used for commercial or professional purposes warranty is null and void.

If, within the period of the warranty, the purchaser returns to our factory or authorised Kerrick service outlet with satisfactory evidence of purchase date freight prepaid for both delivery and return, any parts or product claimed to be defective, Kerrick will, at its option, repair or replace any such defective parts if Kerrick deems them to be defective. The purchaser shall, however, be responsible for any removal or installation charges relating to the said parts and such replacement or repair shall constitute the sole liability of Kerrick and the sole remedy of the purchaser.

Without limiting the generality of the foregoing, but subject to any relevant statute, this warranty shall not cover replacement or repair on account of fair wear and tear, faulty operation contrary to Kerrick's printed instructions, unauthorised repair or alteration, negligence, misuse, incorrect operation or accident, failure to service filter or motor flooding, or using domestic designed equipment for commercial or industrial purposes. No warranty is given for equipment that has been serviced or repaired by Kerrick, other than for new parts supplied during such repair.

This warranty is given in lieu of all other warranties, whether express or implied, all of which are hereby excluded, subject nevertheless to any applicable provision of any act or statute.

Dealers Name:

Address:

P/Code

Phone No:

Date of Purchase:

Model No:

Serial No:

Dealers Signature:

This section should be retained by the purchaser and surrendered to the dealer on authorised agent should a guarantee repair be necessary.

KERRICK INDUSTRIAL COMPANY

9663-5428



**OPERATION
AND
MAINTENANCE
OF YOUR
QUALITY**

KERRICK

**UPHOLSTERY &
CARPET CLEANING
MACHINE**



Sydney 69 Derby Street, Silverwater, 2128. (02) 9737 9797. Fax: (02) 9737 9898

Melbourne 20 Egan Road Dandenong 3175. (03) 9769 2577. Fax: (03) 9769 2599

Brisbane 37 Sandgate Road, Albion, 4010. (07) 3862 4900. Fax: (07) 3862 1088

Perth 9/54 Prindville Drive, Wangara. 6065. (08) 9309 3262 Fax: (08) 9309 3962

Adelaide Sales 0411 876 652

Auckland 12 Green Park Road, Penrose. (09) 579 2674. Fax: (09) 525 0861

Wellington 95 Nelson Street, Petone. (04) 568 7344. Fax: (04) 568 7461

Hamilton Sales (07) 839 5350

Christchurch Sales (03) 365 5886. Fax: (03) 365 4144

Dunedin Sales (03) 477 7096. Fax: (03) 477 7099

9360

SALES AGENT:-

MAINTENANCE

The machine should be cleaned daily after finishing work. The system, including the chemical intake, should be flushed out after use with clean water. Clean the strainers, nozzles, floor tool and suction hose. Examine hoses and electrical wiring for damage or wear. Check hose connections and couplings for leaks and replace as necessary. Motor brushes should be replaced every 200 running hours minimum.

NOTE

Incorrect use or failure to follow the operating and maintenance procedure may produce an injury.
IF ASSISTANCE IS REQUIRED, CONTACT YOUR LOCAL KERRICK SERVICE AGENT OR KERRICK INDUSTRIAL EQUIPMENT.

- Remember to unplug from the power point prior to opening the cleaner for maintenance, etc. The cleaner should never be immersed in water. Solvents or strong detergents should never be collected or used to clean the machine.

The manufacturer or supplier shall not be held responsible for any damage caused to persons, animals or objects due to incorrect or irrational use or non-observance of these instructions.

Kerrick Extractors are supplied with various tooling options. Your selling agent will advise you on the tooling package supplied with your machine.

When using hot water for upholstery/carpet cleaning, water temperature MUST NOT exceed 60°C

MODELS:

Commercial { CLIP - Multi-purpose (cleans carpet, hardfloor, upholstery)
 SCUP - Detailing upholstery/cleaning

Domestic { LAVA/ZIP -Multi-purpose (cleans carpets, hardfloor, upholstery)

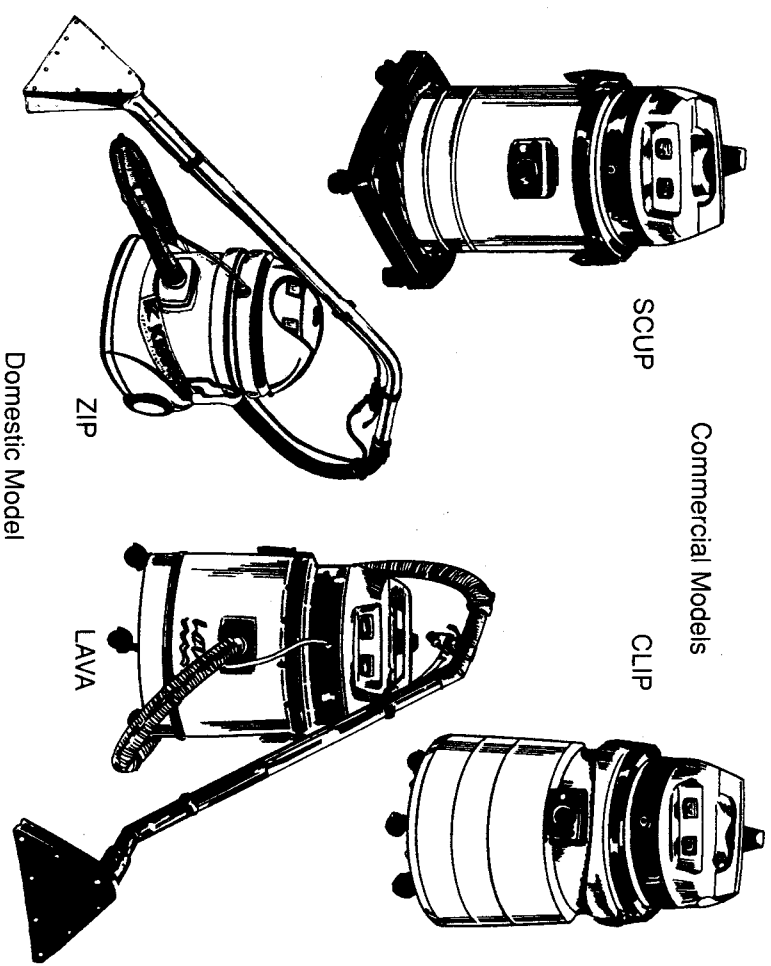

Domestic Model

DRY VACUUM OPERATION CALIFORNIA/GARAGE

Remove detergent suction and discharge tube (G & F) from head (A) undo toggle latches and remove head, clean and dry tank. Fit filter bag and filter bag ring (4), also ensure that filter bag stretcher (3) is in place on underside of head (1), replace head and do up toggle latches, fit the tool selected for the job, switch on suction motors (2) (not pump) and carry out normal vacuuming.

- 1) Empty tank after use,
- 2) Remove and clean filter bag after each use,
- 3) Never allow tank to overflow.

WET PICK UP OPERATION "CALIFORNIA"

Assemble machine following same procedure as for carpet cleaning, substitute floor tool (39) and wand (49) where supplied. Tool (39) is a multi-purpose tool with insert and can be adjusted to various cleaning jobs. The height adjustment is made by turning the thumb screw (1) until the wheels (2) hold the suction head on the required level. In order to exchange the insert rails loosen the thumb screw (1) so much that the wheel axle (2) can be swung up, whereupon the backstop (3) is turned up in a vertical position. Now the insert rails can be exchanged.

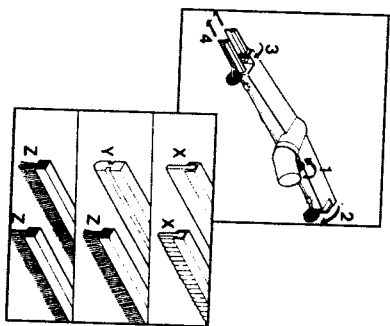
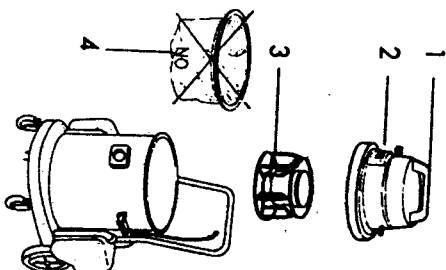
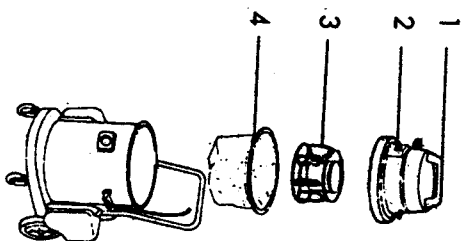

DRY VACUUMING

- 1 - Remove the clean water tank with liquids float from the main tank on all models except Zip.
- 2 - Set the cloth filter with filter stretching basket (A) (B) into the main tank (E).
- 3 - Hook up the motor head on to the main tank and lock it up with the two clips.
- 4 - Fix the flexible hose into the suction inlet.
- 5 - Screw the top wand (P) onto the suction hose.
- 5a - Fit the two piece extension wand (M&O) together.
- 6 - Fit top curved (P) into extension.
- 7 - Fix the most suitable accessory for the job to the lower extension.
- 8 - Activate suction by pressing the red switch, after having connected the machine to the power socket.
- 9-10-11-12-12a Typical examples of dry vacuuming.

WET VACUUMING

- 13 - Remove the cloth filter (B) together with the filter stretching basket (A) from the main tank.
- 14 - Set the clean water tank with liquids float into the main tank except model Zip.
- 15 - Place the motor head on the tank, ensuring the chemical suction tube is placed in the smaller opening leading to the clean water tank. Clip the motor head into place. All models except Zip.
- 16 - Fix the flexible hose into the suction inlet.
- 17/17a - Follow fitting of top wand as detailed in 5&6 above.

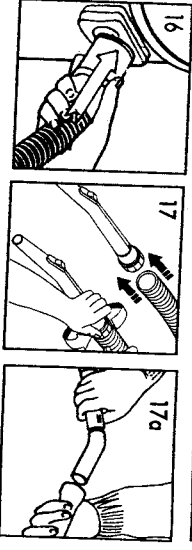
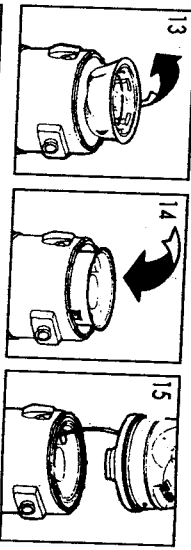
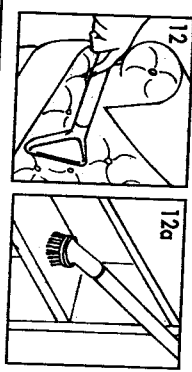
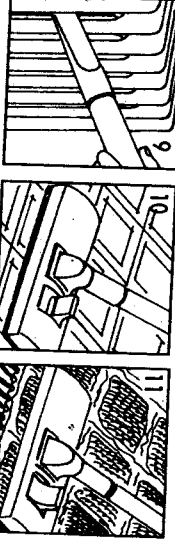
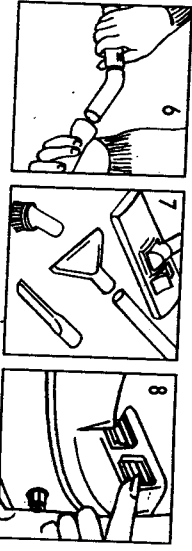
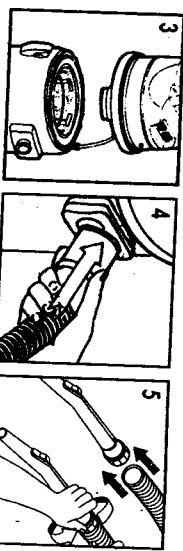
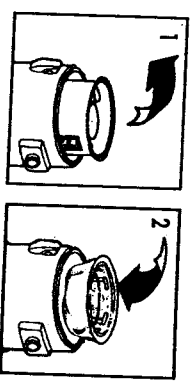

17/17a - Follow fitting of top wand as detailed in 5&6 above.