

## Arbortech AS170 MOTOR - Australia

## AS170 MOTOR LIST AND REF. DIAGRAM

KEY #	PART #	DESCRIPTION	# IN PACK	RRP inc GST	DEALER ex GST
M	ALL.FG.MOTOR1703.00	MOTOR, AS170 1250W 240V		DISCONTINUED	
1	ALL.FG.ARMATUR170.00	ARMATURE ASSEMBLY 1250W 240V	1	209.99	133.63
2	ALL.FG.FIELD170	FIELD CASING	1	64.99	41.36
5	ALL.FG.BRUSH1705	BRUSH, HOLDER	2	24.99	15.90
6	623592-00	FELT SEAL	4	TBA	TBA
8	ALL.FG.BRUSH1703	BRUSH, CARBON 240V	2	46.19	29.39
9	648613-00	BRUSH SPRING	2	TBA	TBA
10	623591-00	CAP	2	TBA	TBA
11	593685-00	SCREW	2	TBA	TBA
12	ALL.FG.HANDLE17002	REAR HANDLE - BOTH HALVES	1	64.99	41.36
13	ALL.FG.SWITCH1702	SWITCH, 1250W 240V	1	99.99	63.63
14	623581-00	SEPARATOR - DUST FAN	1	TBA	TBA
16	543889-00	CORD CLAMP	1	TBA	TBA
17	330019-03	SCREW	1	TBA	TBA
18	330005-01	PROTECTOR, CORD	1	TBA	TBA
24	ALL.FG.CORD170.00	CORD, AS170 - 230V	1	99.99	63.63
26	623593-00	BRUSH WIRE TERMINAL	2	TBA	TBA
35	646012-00	FELT SEAL	1	TBA	TBA
36	ALL.FG.BRUSH1706	BRUSH COVER, ELECTRIC	2	41.99	26.72
37	648777-00	SCREW	2	TBA	TBA
60	387746-00	SCREW	4	TBA	TBA
61	330065-07	SCREW	1	TBA	TBA
70	604484-00	NUT ARMATURE ASSEMBLY	1	TBA	TBA
71	629797-00	PINION ARMATURE ASSEMBLY	1	TBA	TBA
72	ALL.FG.BEARING007	BEARING, FRONT ARMATURE ASSEMBLY	1	14.99	9.54
73	623617-00	FELT SEAL ARMATURE ASSEMBLY	1	TBA	TBA
74	623580-00	BEARING RETAINER ARMATURE ASSEMBLY	1	TBA	TBA
75	623613-00	SLINDER ARMATURE ASSEMBLY	1	TBA	TBA
76	ALL.FG.BEARING008	BEARING, REAR ARMATURE ASSEMBLY	1	14.99	9.54
77	641823-00	BEARING CUP ARMATURE ASSEMBLY	1	TBA	TBA
78	ALL.FG.FIELD170.00	FIELD ASSEMBLY, 1250W 240V	1	209.99	133.63
79	623572-00	FAN BAFFLE	1	TBA	TBA
80	330065-25	SCREW	4	TBA	TBA
91	620051-00	PAD	2	TBA	TBA
94	640723-00	BAFFLE	1	TBA	TBA
97	646860-00	CAPACITOR 1250W 240V	1	TBA	TBA
98	650937-00	INSULATING PAPER	1	TBA	TBA
836	233804-36	TORX DRIVER T6-BRUSH ARM SCREW	1	TBA	TBA

Arbortech AS170 MOTOR DIAGRAM - Australia

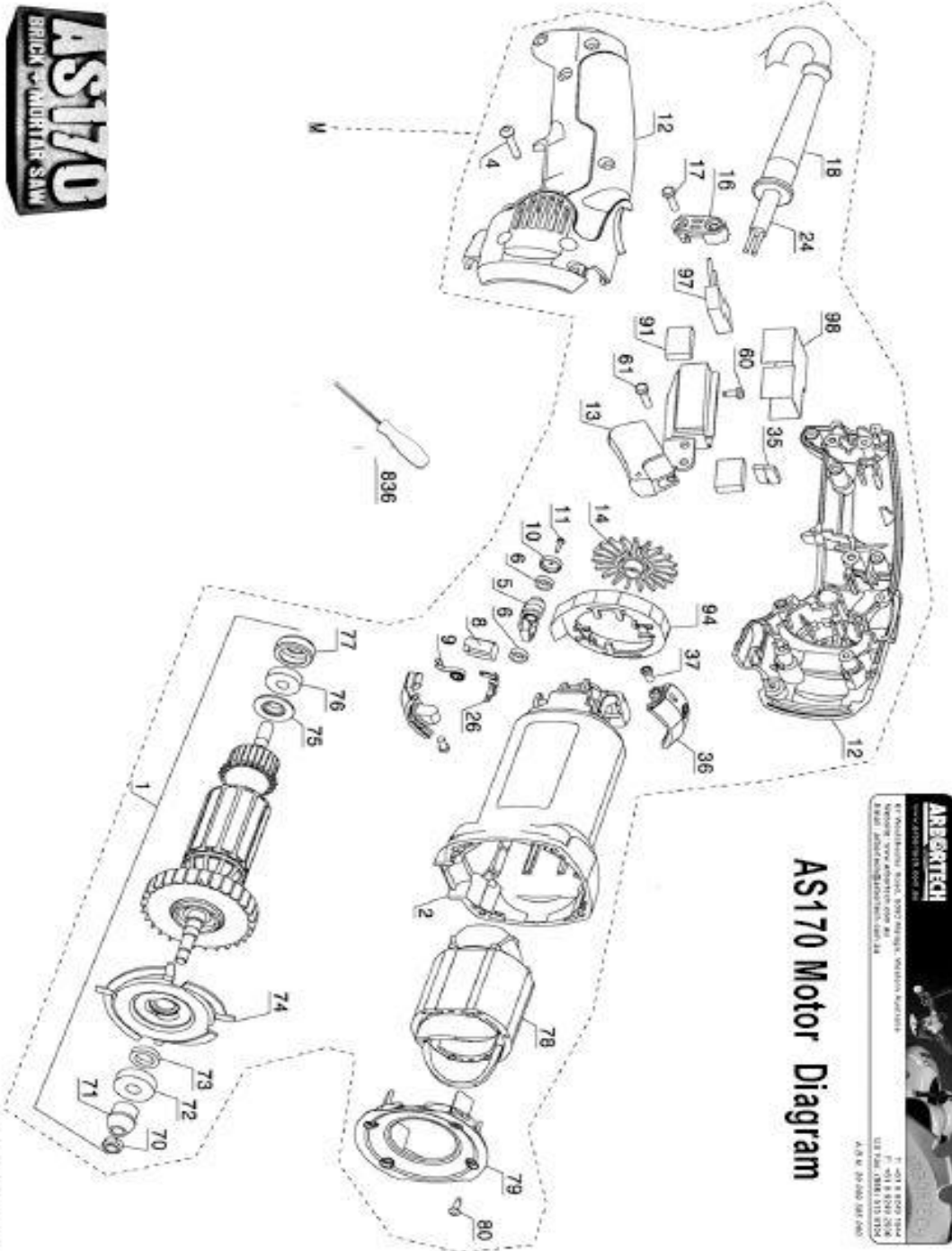

REV: AS17 0290009



