

Fleet type: 0566 Concrete Grinder Hand Held

Manual #: 315

00

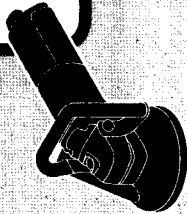
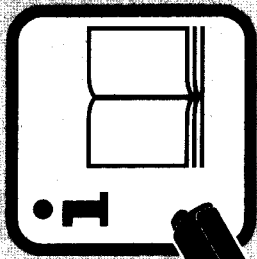

GBR 14 CA

D	4 ...7
GB	8 ...11
F	12 ...15
E	16 ...19
P	20 ...23
I	24 ...27
NL	28 ...31
DK	32 ...35
S	36 ...39
N	40 ...43
FIN	44 ...47
GR	48 ...51
TR	52 ...55

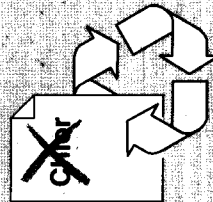

BOSCH

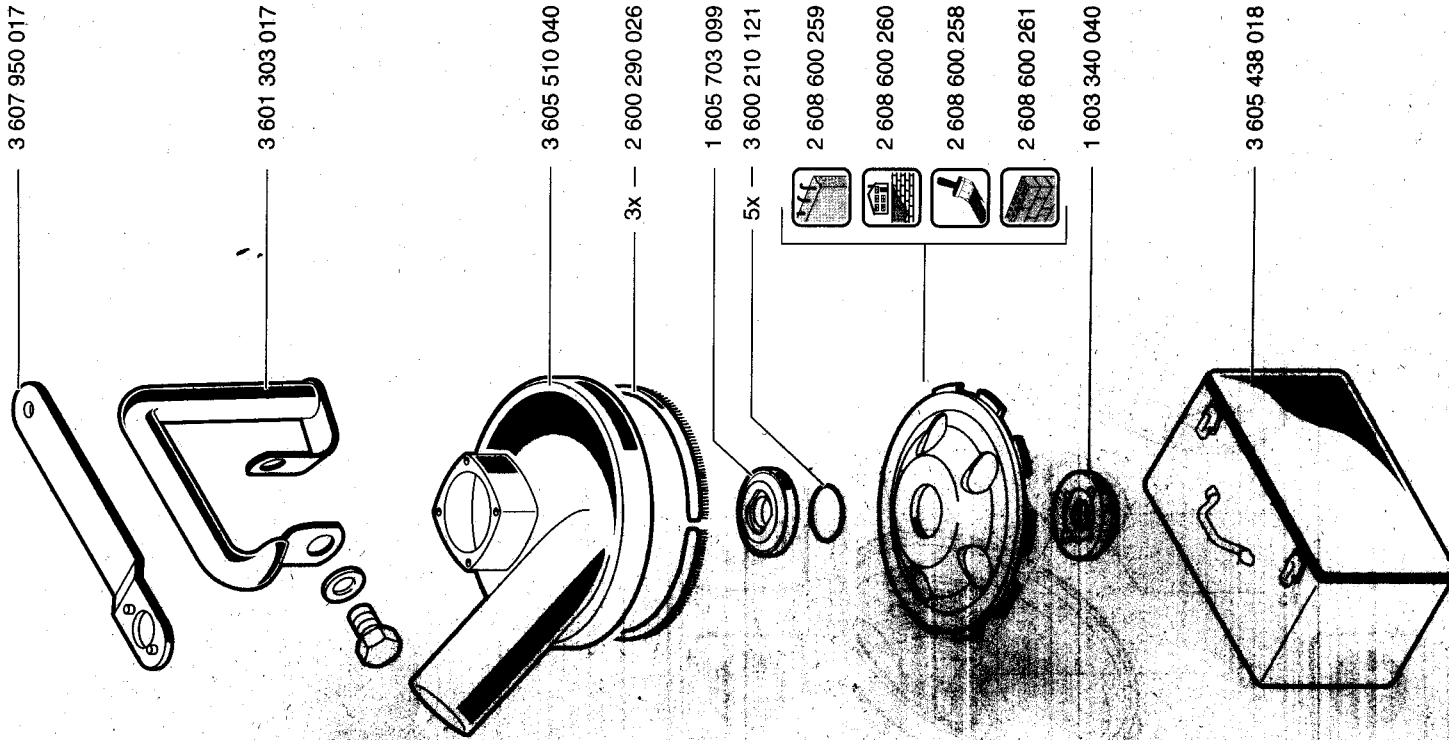

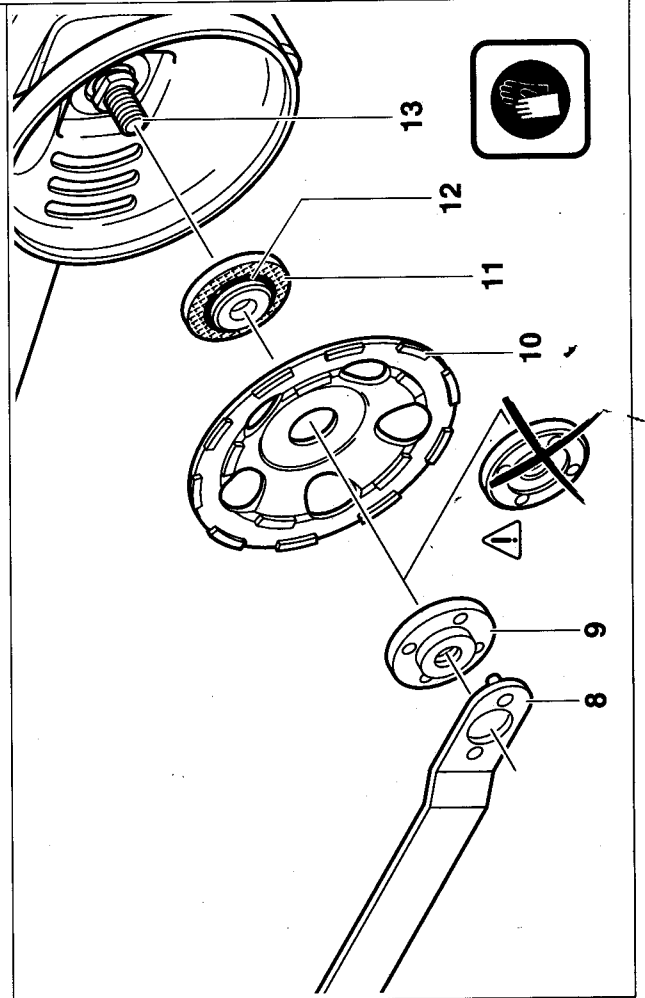
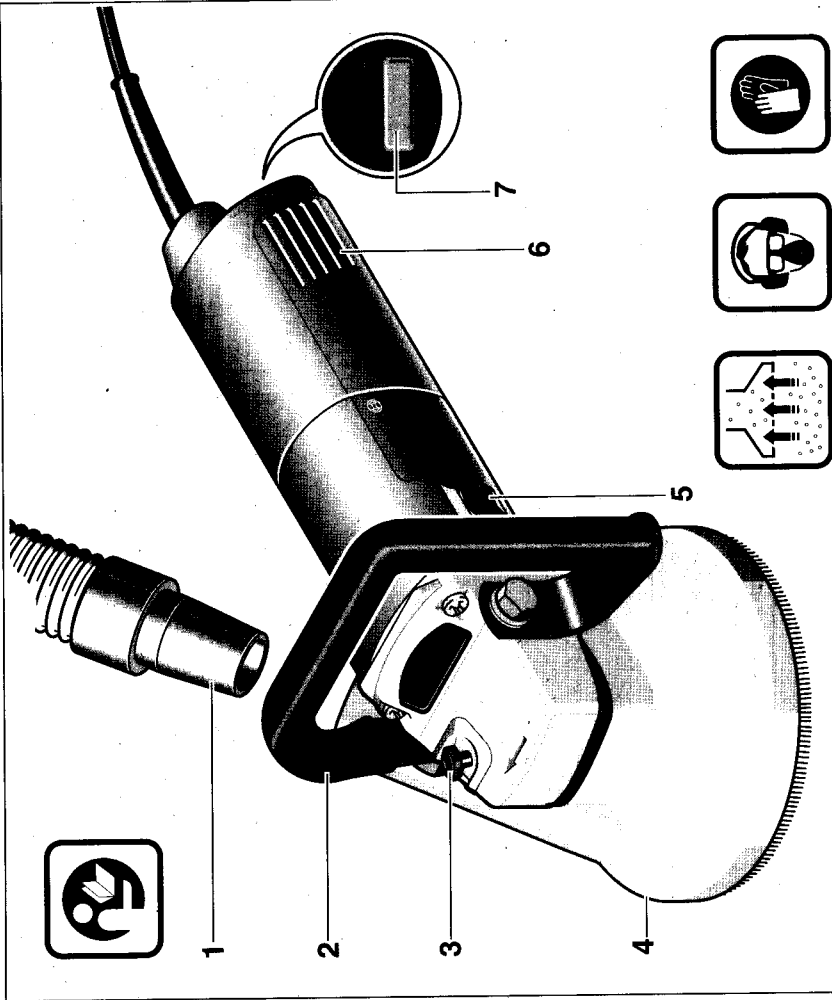

3) Personal safety

- a) Stay alert, watch what you are doing and use common sense when operating a power tool. Do not use a power tool while you are tired or under the influence of drugs, alcohol or medication. A moment of inattention while operating power tools may result in serious personal injury.
- b) Use safety equipment. Always wear eye protection. Safety equipment such as dust mask, non-skid safety shoes, hard hat, or hearing protection used for appropriate conditions will reduce personal injuries.
- c) Avoid accidental starting. Ensure the switch is in the off position before plugging in. Carrying power tools with your finger on the switch or plugging in power tools that have the switch on invites accidents.
- d) Remove any adjusting key or wrench before turning the power tool on. A wrench or a key left attached to a rotating part of the power tool may result in personal injury.
- e) Do not overreach. Keep proper footing and balance at all times. This enables better control of the power tool in unexpected situations.
- f) Dress properly. Do not wear loose clothing or jewellery. Keep your hair, clothing and gloves away from moving parts. Loose clothes, jewelry or long hair can be caught in moving parts.
- g) If devices are provided for the connection of dust extraction and collection facilities, ensure these are connected and properly used. Use of these devices can reduce dust related hazards.

die Sicherheit des Gerätes erhalten bleibt.

General Safety Rules

WARNING! Read all instructions. Failure to follow all instructions listed below may result in electric shock, fire and/or serious injury. The term "power tool" in all of the warnings listed below refers to your mains operated (corded) power tool or battery operated (cordless) power tool.

SAVE THESE INSTRUCTIONS.

- 1) Work area
 - a) Keep work area clean and well lit. Cluttered and dark areas invite accidents.
 - b) Do not operate power tools in explosive atmospheres, such as in the presence of flammable liquids, gases or dust. Power tools create sparks which may ignite the dust or fumes.
 - c) Keep children and bystanders away while operating a power tool. Distractions can cause you to lose control.

2) Electrical safety

- a) Power tool plugs must match the outlet. Never modify the plug in any way. Do not use any adapter plugs with earthed (grounded) power tools. Unmodified plugs and matching outlets will reduce risk of electric shock.
- b) Avoid body contact with earthed or grounded surfaces such as pipes, radiators, ranges and refrigerators. There is an increased risk of electric shock if your body is earthed or grounded.
- c) Do not expose power tools to rain or wet conditions. Water entering a power tool will increase the risk of electric shock.
- d) Do not abuse the cord. Never use the cord for carrying, pulling or unplugging the power tool. Keep cord away from heat, oil, sharp edges or moving parts. Damaged or entangled cords increase the risk of electric shock.
- e) When operating a power tool outdoors, use an extension cord suitable for outdoor use. Use of a cord suitable for outdoor use reduces the risk of electric shock.

- e) Maintain power tools. Check for misalignment or binding of moving parts, breakage of parts and any other condition that may affect the power tools operation. If damaged, have the power tool repaired before use. Many accidents are caused by poorly maintained power tools.

- f) Keep cutting tools sharp and clean. Properly maintained cutting tools with sharp cutting edges are less likely to bind and are easier to control.
- g) Use the power tool, accessories and tool bits etc., in accordance with these instructions and in the manner intended for the particular type of power tool, taking into account the working conditions and the work to be performed. Use of the power tool for operations different from those intended could result in a hazardous situation.

5) Battery tool use and care

- a) Ensure the switch is in the off position before inserting battery pack. Inserting the battery pack into power tools that have the switch on invites accidents.
- b) Recharge only with the charger specified by the manufacturer. A charger that is suitable for one type of battery pack may create a risk of fire when used with another battery pack.
- c) Use power tools only with specifically designed battery packs. Use of any other battery packs may create a risk of injury and fire.
- d) When battery pack is not in use, keep it away from other metal objects like paper clips, coins, keys, nails, screws, or other small metal objects that can make a connection from one terminal to another. Shorting the battery terminals together may cause burns or a fire.
- e) Under abusive conditions, liquid may be ejected from the battery; avoid contact. If contact accidentally occurs, flush with water. If liquid contacts eyes, additionally seek medical help. Liquid ejected from the battery may cause irritation or burns.

6) Service

- a) Have your power tool serviced by a qualified repair person using only identical replacement parts. This will ensure that the safety of the power tool is maintained.

- b) Do not use the power tool if the switch does not turn it on and off. Any power tool that cannot be controlled with the switch is dangerous and must be repaired.
- c) Disconnect the plug from the power source before making any adjustments, changing accessories, or storing power tools. Such preventive safety measures reduce the risk of starting the power tool accidentally.
- d) Store idle power tools out of the reach of children and do not allow persons unfamiliar with the power tool or these instructions to operate the power tool. Power tools are dangerous in the hands of untrained users.

4) Power tool use and care

- a) Do not force the power tool. Use the correct power tool for your application. The correct power tool will do the job better and safer at the rate for which it was designed.

- b) Do not use the power tool if the switch does not turn it on and off. Any power tool that cannot be controlled with the switch is dangerous and must be repaired.

- c) Disconnect the plug from the power source before making any adjustments, changing accessories, or storing power tools. Such preventive safety measures reduce the risk of starting the power tool accidentally.

- d) Store idle power tools out of the reach of children and do not allow persons unfamiliar with the power tool or these instructions to operate the power tool. Power tools are dangerous in the hands of untrained users.

Tool Specifications

GB

Concrete Grinder
Part number 0 601 773 7...
Power consumption 1400 W
Output power 820 W
No-load speed 11000 RPM
Diamond grinding disc dia. 125 mm
Spindle thread M 14
Weight (without accessory) approx. 2.7 kg
Protection class II / I

Noise/Vibration Information

Measured values determined according to EN 50 144.

The A-weighted noise levels of the tool are typically: Sound pressure level: 88 dB (A). Sound power level: 101 dB (A).

Wear ear protection!

The weighted acceleration is typically 4 m/s².

Use as intended

The machine is intended for grinding, deburring and smoothing of mainly mineral materials such as, for example, concrete, stone, marble and poured flooring without the use of water. It is also suitable for the removal of protective coatings and adhesive residue.

Operating controls

- 1 Vacuum hose
- 2 Handle
- 3 Spindle locking button
- 4 Guard with replaceable brush insert
- 5 ON/OFF switch
- 6 Ventilation slots
- 7 Service indicator
- 8 Two-hole spanner for clamping nut
- 9 Clamping nut
- 10 Diamond grinding disc
- 11 Mounting flange
- 12 O-ring
- 13 Grinding spindle

Not all of the accessories illustrated or described are included as standard delivery.

For your safety



Working safely with this machine is possible only when the operating and safety information are read completely and the instructions contained therein are strictly followed. In addition, the general safety instructions in the enclosed booklet must be followed. Before using for the first time, ask for a practical demonstration.

If the cable is damaged or cut through while working, do not touch the cable but immediately pull the mains plug. Never use the machine with a damaged cable.

Wear protective goggles, ear protectors and face mask. When necessary, also wear an apron.

Wear protective gloves and sturdy shoes.

Do not work with materials containing asbestos.

Operate the machine only with guard 4 and handle 2.

Use only grinding discs whose allowable speed is at least as high as the no-load speed of the machine.

The diamond grinding disc must be properly mounted and free to rotate.

Strongly vibrating diamond grinding discs and those with missing or damaged segments must not be used.

Always direct the cable to the rear away from the machine.

Connect machines that are used in the open via a residual current circuit breaker with a tripping current of 30 mA maximum. Use only extension cables that are intended for outdoor use and are protected against splash water.

Insert the mains plug only when the machine is switched off.

When working with the machine, always hold firmly with both hands and provide for a secure stance.

Keep hands away from rotating diamond grinding disc.

Apply the machine to the workpiece only when switched on.

Always switch off the machine and allow to come to a stop before putting down.

Bosch can assure flawless functioning of the machine only when original accessories are used.

Replacing the Diamond Grinding Disc

Before any work on the machine itself, pull the mains plug.

Use only diamond grinding disc whose allowable speed is rated at least as high as the no-load speed of the machine.

Vibrating diamond grinding discs should be changed immediately.

Allow hot diamond grinding disc to cool and wear protective gloves.

Clean the grinder spindle and all parts to be mounted.

With the spindle locking button 3, lock the machine spindle (only when the spindle is at a standstill).

Loosen the clamping nut 9 with the two-hole spanner 8 and unscrew. Remove diamond grinding disc and clean clamping flanges.

Mount new diamond grinding disc in the reverse order. The mounting flange 11 must be properly seated on the grinding spindle with its drive surfaces.

Important: Tighten the clamping flange 9 securely.

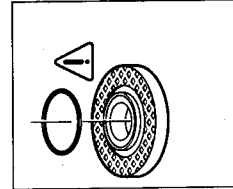

Always use the correct supply voltage. The power supply voltage must match the information quoted on the tool identification plate. Tools with a rating of 230 V can also be connected to a 220 V supply.

Switching on and off

Switching on: Slide ON/OFF switch 5 forwards and depress at the front unit switch locks into position

Switching off: Depress ON/OFF switch 5 at the rear - switch jumps back to its initial position

Test run!

Check grinding tools before use. The grinding tool must be properly mounted and turn freely. Perform a test run for at least 30 seconds without load. Do not use damaged, out of round or vibrating grinding tools.

Starting Current Limiting

As a result of controlled starting of the machine, a 16 A fuse is adequate.

Constant Speed Electronics

The constant speed electronics hold the speed for no load and load nearly constant and ensure uniform working.

Overload Protection

When overloaded, the motor comes to a standstill. Remove load from the machine immediately and allow to cool with no load and highest speed for approx. 30 seconds.

Restarting Protection

Prevents uncontrolled restarting of the machine after a power interruption.

Putting into Operation Again: Switch on-off switch 5 to off position and switch on again.

Operating instructions

- Be careful of hidden electrical lines or gas and water pipes. Check the working area, e.g., with a metal detector.
- Clamp the workpiece in case it does not remain stationary from its own weight.
- Do not load the machine so heavily that it comes to a standstill.
- Wear protective gloves.
- Wear sturdy shoes.



During grinding the diamond grinding disc becomes very hot. Allow to cool before replacing and wear protective gloves.

Apply the machine to the workpiece only when switched on.

Work with moderate advancing.

For the removal of coatings, for example, the machine can also be held at a small angle to the workpiece surface without reducing the effect of the dust extraction.

The diamond grinding disc included with the machine is intended for hard material. A dull diamond grinding disc can be sharpened in abrasive material (e.g., chalky sand stone).

The protective guard 4 with the brush insert in the rim and the diamond grinding disc from Bosch are matched to each other. This ensures optimum utilisation of the diamond coating and the dust vacuuming.

Dust extraction

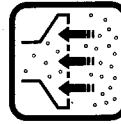

The machine must be operated only with dust extraction.

In addition, wear a dust mask.

The vacuum cleaner must be qualified for the extraction of masonry dust.

Replacing the Brush Insert

- Before any work on the machine itself, pull the mains plug.
Replace a worn out brush insert in the protective guard 4 in the following manner.
With the diamond grinding disc mounted, carefully pry out the brush insert at the cut-outs in the brush guide with a screwdriver using the diamond grinding disc as a fulcrum.
Press the new brush insert carefully into the brush guide to the stop. Pay attention when inserting that the end of the brush insert does not lie in a cut-out in the brush guide.

Optional extras

Four different diamond grinding discs are available as optional extras. Examples for their use can be found in the table.

Grinding disc type Order No. 2 608 600 ...	BPP -259	APP -260	SPP -258	UPP-T -261
Old/Hard concrete	x			
Flooring concrete, Lime plaster,		x		
Abrasive concrete, Sand stone, Asphalt				x
Thermoplastic protective coating				
Granite, Artificial stone, Universal concrete				x

Maintenance and Cleaning

- Before any work on the machine itself, pull the mains plug.



For safe and proper working, always keep the machine and the ventilation slots clean.



In extreme working conditions, conductive dust can accumulate in the interior of the machine when working with metal. The protective insulation of the machine can be degraded. The use of a stationary extraction system is recommended in such cases as well as the frequent blowing out of the ventilation slots and the installation of a residual current circuit breaker.

If the machine should happen to fail despite the care taken in manufacture and testing, repair should be carried out by an authorised customer services agent for Bosch power tools.

For all correspondence and spare parts orders, always include the 10 digit order number from the nameplate of the machine!

WARNING! Important instructions for connecting a new 3-pin plug to the 2 wire cable.

The wires in the cable are coloured according to the following code:

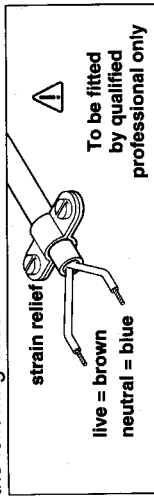

Do not connect the blue or brown wire to the earth terminal of the plug.

Important: If for any reason the plug is cut off of the cable of this machine, it must be disposed of safely and not left unattended.

Service Indicator 7

If the service indicator 7 begins to blink or lights continuously, the machine switches itself off after approx. 8 hours of operation and must be taken to customer service for maintenance (for addresses, see Section "Service").



Recycle raw materials instead of disposing as waste.

Machine, accessories and packaging should be sorted for environment-friendly recycling.

These instructions are printed on recycled paper manufactured without chlorine. The plastic components are labelled for categorized recycling.

Service

Great Britain

Robert Bosch Ltd. (B.S.C.)
P.O. Box 98
Broadwater Park
North Orbital Road
Denham-Uxbridge
GB-Middlesex UB 9 5HU

☎ Service (0 18 95) 83 87 82
☎ Advice line (0 18 95) 83 87 91
FAX (0 18 95) 83 87 90

Ireland

Beaver Distribution Ltd.
Greenhills Road
IRL-Tallaght-Dublin 24

☎ Service (01) 45 15 211
FAX (01) 45 17 127

CE Declaration of conformity

We declare under our sole responsibility that this product is in conformity with the following standards or standardization documents:

EN 50 144, EN 55 014, EN 61 000-3, HD 400 according to the provisions of the regulations 73/23/EEC, 89/336/EEC, 98/37/EC.

CE 98

Dr. Alfred Odendahl

Dr. Eckerhard Ströigen

ppa Odendahl i.v. Ströigen

Robert Bosch GmbH
Geschäftsbereich Elektrowerkzeuge