

STUBBIE 1 BRICKSAW

P L A N T  
H A Z A R D  
L I S T

Some of the questions  
you should ask to  
help identify hazards  
arising from plant

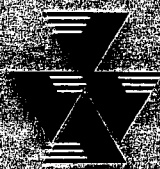

VICTORIAN  
WORKCOVER  
AUTHORITY



## STUBBIE 1 AND STUBBIE 2



Stubbie 1

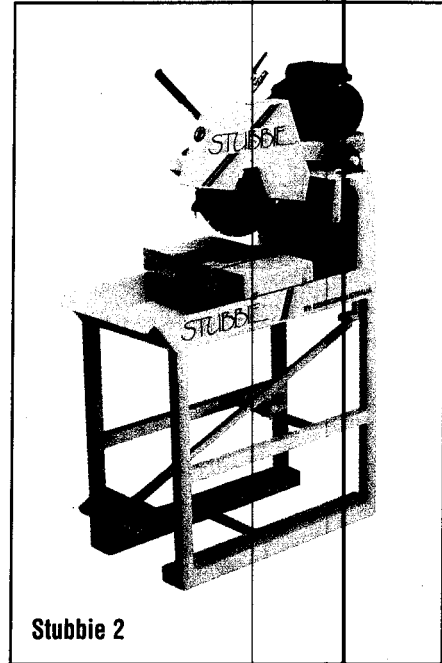

Stubbie 2

Built-in reliability and longevity have made "Stubbie" the industry standard for heavy-duty brick saws.

Thousands of "Stubbies" are consistent performers in hire shops, building sites and testing labs - many of them in regular use for over 10 years.

**Stubbie 1** is the ideal, long-term, portable brick saw for pavers, bricks and tiles, with a fold-away stand, suitable for all site work.

**Stubbie 2** has all the same construction as the Stubbie 1, but features a fixed box section stand, making it the ideal saw for more permanent locations, such as core testing laboratories or production facilities.

### Built Tough:

- The 3mm laser cut structural steel frame folded to produce an extremely stable, rigid and vibration resistant frame.
- All precision welds are ground to provide a smooth finish and resistance to cracking. Structural cross members are built into the table and head assembly to ensure maximum rigidity and produce minimal flexing and distortion in use or transportation.
- Heavy-duty sealed "pillow block" roller bearings are fitted to the 25.4mm (1") single piece blade shaft and inner flange, providing ideal running conditions for the diamond blade.

### Low Maintenance:

- Industrial-duty, dual V-belts, run on machined key-lock pulleys and rarely require attention.
- The purpose built electric motor with overload protection is fully sealed and designed for continuous operation. All electrical components are IP55 rated and C-Tick approved.
- The heavy-duty conveyor cart runs on high quality sealed bearings for smooth, long term operation.

### User Friendly:

- A removable foot pedal and spring counterbalance system, provide smooth lowering into the cut, either by foot or by hand. The head can be fixed in any position and a locking bolt ensures the blade cannot be lowered into the conveyor cart.

- The precision and rigidity achieved, offer cuts smooth enough to allow chip-free cutting of most tiles.
- A variable angle mitre guide is included for repetition cuts of 45° to 90°.
- The positioning of the blade guard offers excellent visibility of the cut and is folded to reduce water spray.
- The standard rotation, petrol motor model allows for economical replacement motors of any equivalent brand to be fitted.

Model Item No.	Stubbie 1 BS1-STUB1-2HE1	Stubbie 2 BS2-STUB2-2HE2
Max Depth of Cut	125mm	125mm
Blade Diameter	350mm (14")	350mm (14")
Max Length of Cut	420mm	420mm
Electric Motor	2.4 HP, 9.5 Amp, 50 Hz	2.4 HP, 9.5 Amp, 50 Hz
Petrol Motor Power	5.5 HP Honda - standard rotation	5.5 HP Honda - standard rotation
Stand Type	Collapsible with foot pedal	Fixed box section
Dimensions (HxWxL)	730 x 450 x 960mm	1480 x 450 x 1070
Weight (uncrated)	74kg Stand 19kg	88kg
Options	Core Sawing Kit Electric or Belt Driven Water Recirculating Pump, Wheel Kit & Handles, Side Carry Handles, Roll/Lifting Frame, Laser Cut Name Plate, Custom Paint	Core Sawing Kit Electric or Belt Driven Water Recirculating Pump, Wheel Kit & Handles, Side Carry Handles, Roll/Lifting Frame, Laser Cut Name Plate, Custom Paint

Brick & Masonry Saws

**✦ Work Cover Safety**  
*...think it, talk it, work it*

This checklist provides a typical range of questions that can be asked to help with the identification of hazards associated with plant. It may be used as a starting point, with certain questions added or deleted to make the checklist appropriate to the plant and associated systems of work being examined.

If "yes" is the answer to a question in the checklist, the plant, parts of the plant and/or the situation associated with the hazard, should be identified on the checklist.

The following are examples of hazards identified and recorded in checklists:

- "Someone's fingers may get caught between the two rollers of the paper processing machine."

- "The pipe containing high pressure fluids in the stamping machine may burst."

- "The boom of the mobile crane may touch the overhead powerlines."

- "People may trip over the electric power lead for the bench grinder."

When completing the checklist, consider the hazards that may affect:  
plant operators;  
anyone working, or in the vicinity of the plant; and  
others who could be affected, such as visitors, contractors, etc.

# H A Z A R D C H E C K L I S T

## C CUTTING, STABBING AND PUNCTURING

1. Can anyone be cut, stabbed or punctured due to:
  - a. coming in contact with sharp or flying objects?

BEWARE OF ROTATING BLADE AT ALL TIMES WHEN OPERATING MACHINE.

- b. coming in contact with moving parts of the plant during testing, inspection, operation, maintenance, cleaning or repair of the plant?

REFER ABOVE.

- c. the plant, parts of the plant or work pieces disintegrating?

- d. work pieces being ejected?

ENSURE OPERATOR HAS FIRM CONTROL OF MATERIAL TO BE CUT.

- e. the mobility of the plant?

- f. uncontrolled or unexpected movement of the plant?

- g. other factors not mentioned?

\_\_\_\_\_

\_\_\_\_\_

\_\_\_\_\_

## D SHEARING

1. Can anyone's body parts be sheared between two parts of the plant, or between a part of the plant and a work piece or structure?

## E FRICTION

1. Can anyone be burnt due to contact with moving parts or surfaces of the plant, or material handled by the plant?

If "yes" the answer to a question the checklist the plant parts of the plant and/or the situation associated with the hazard should be written the space provided

# H A Z A R D C H E C K L I S T

## A ELECTRICAL

<p>1. Can anyone be injured by electrical shock or burnt due to:</p> <p>a. the plant contacting live electrical conductors?</p>	
<p>b. the plant working in close proximity to electrical conductors?</p>	
<p>c. overload of electrical circuits?</p>	
<p>d. damaged or poorly maintained electrical leads and cables?</p>	<p>ENSURE POWER LEAD AND PLUG ARE IN GOOD CONDITION.</p>
<p>e. damaged electrical switches?</p>	<p>ENSURE SWITCH IS IN GOOD CONDITION WITH NO CRACKS IN THE CASE.</p>
<p>f. water near electrical equipment?</p>	<p>SWITCH GEAR AND MOTOR ARE MANUFACTURED TO IP54 STANDARD.</p>
<p>g. lack of isolation procedures?</p>	
<p>h. other factors not mentioned?</p> <p>_____</p> <p>_____</p> <p>_____</p>	<p>AS AN ADDED SAFETY PRECAUTION THIS UNIT SHOULD BE OPERATED ON A CIRCUIT THAT IS PROTECTED BY AN EARTH LEAKAGE CONTACTOR.</p>

## I EXPLOSION

<p>1. Can anyone be injured by explosion of gases, vapours, liquids, dusts or other substances, triggered by the operation of the plant or by material handled by the plant?</p>	
--	--

If "yes" the answer to a question on the checklist the plant parts of the plant and/or the situation associated with the hazard should be written in the space provided

# H A Z A R D C H E C K L I S T

## **H** ERGONOMIC

1. Can anyone be injured due to:

a. poorly designed seating?

b. repetitive body movement?

c. constrained body posture or the need for excessive effort?

SEEK ASSISTANCE WHEN  
MOVING MACHINE.

d. design deficiency causing mental or psychological stress?

e. inadequate or poorly placed lighting?

f. lack of consideration given to human error or human behaviour?

g. mismatch of the plant with human traits and natural limitations?

h. other factors not mentioned?

\_\_\_\_\_

\_\_\_\_\_

\_\_\_\_\_

{For more information on hazards associated with manual handling, refer to the Victorian Manual Handling Code of Practice.}

## **L** SUFFOCATION

1. Can anyone be suffocated due to lack of oxygen, or atmospheric contamination?

If "yes" is the answer to a question in the checklist, the plant, parts of the plant and/or the situation associated with the hazard should be written in the space provided.

# Stubbie

BRICK, MASONRY &  
REFRACTORY SAWS

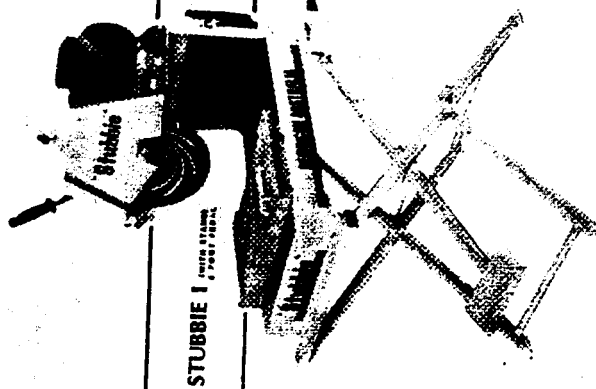

STUBBIE I  
POWER SYSTEM  
HAND SAW

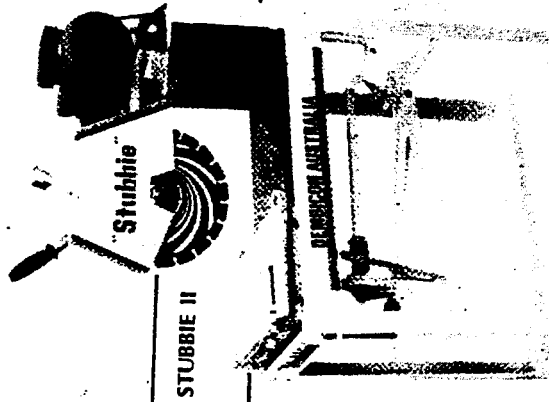

STUBBIE II

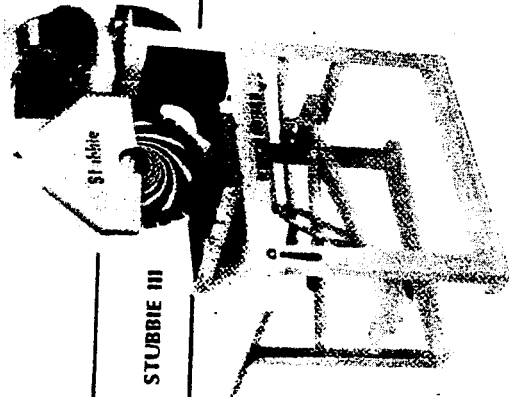

STUBBIE III



**DEMBICON AUSTRALIA**  
AUSTRALIA'S DIAMOND TOOL AND  
CONSTRUCTION EQUIPMENT SPECIALISTS

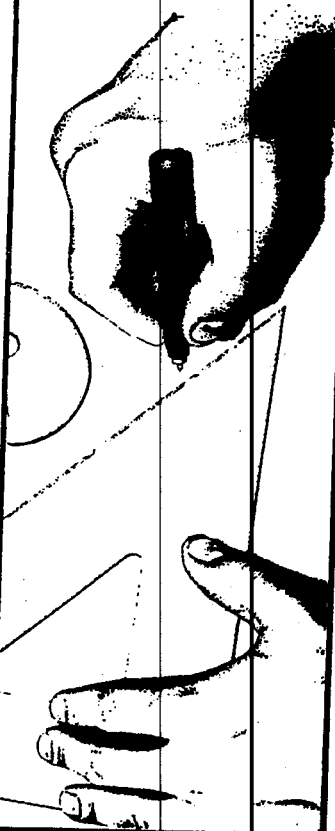

## TECHNICAL MANUAL & SPARE PARTS LIST



# STUBBIE I, II & III

## OPERATING INSTRUCTIONS

### GENERAL

Stubbie I, II & III Tile and Brick saws are universal machines powered either by electric or petrol motors. Both are laser cut and welded steel construction and designed for medium to heavy duty jobs.

Cutting head is supported by pivot-point bearings with locking lever (item 15) which allows the head to be positioned at required cutting depth.

Dual belt drive ensure full power transmission.

Conveyor cart is equipped with Mitre Guide which allows repeat cutting with high accuracy.

For easy maintenance the amount of parts the machine consists of is kept to a minimum and standardised. Frame, cutting head and conveyor cart are Dembicon factory aligned. Misalignment through handling damage or transporting saw can seriously affect blade life.

### TO START SAWING

1. Connect water hose to the top of blade guard (item 18). If submersible pump is used fill the water reservoir pan to within 1" (25mm) of the top. Be sure water pump inlet is fully covered by water at all times. Keep pump intake free of accumulated sludge and other foreign material.
2. Mount the blade solidly and firmly.
3. Adjust the required cutting depth.
4. Turn on the water valve and switch on electric motor or start the engine.
5. Push the conveyor cart with cutting piece gently towards the blade.

## **MAINTENANCE**

1. The sludge that accumulates in the bottom of the water reservoir pan is abrasive and if it accumulates heavily, will shorten the life of the submersible water pump.

Clean water reservoir pan at least once a day - twice a day in heavy cutting and refill with clean water.

2. At the end of each day's use, clean the sludge from the saw.
  - Clean and grease moving parts.
  - For bearings use Shell Alvania grease or equivalent.
3. Keep drive belts tight.
  - Belts are properly tensioned at the Dembicon factory.
  - To obtain accurate V-Belt setting when changing the belts, a V-Belt tension tester should be used.
  - Check the setting on a single belt.
  - Apply load at the centre of the belt span. Deflection should be 8mm for 1 to 1.5kg load.
4. Blades must fit arbor snugly otherwise pounding will occur and seriously damage the blade. It is recommended to use Dembicon blades.
  - Contact your Dembicon dealer for the correct selection of diamond blades.
  - **Note:** A specialised blade that is most efficient for extremely hard, vitreous glazed tile, cannot be the most efficient blade to use on the softest, coarsest of light aggregate block.

<b>Nominal Blade Diameter</b>	<b>Nominal Cutting Depth</b>	<b>Optimal RPM</b>
350 mm (14")	110 mm	3200
400 mm (16")	145 mm	2800
500 mm (20")	180 mm	2100

## **IMPORTANT**

ALWAYS USE THE APPROPRIATE DIAMOND BLADE.

AVOID JAMMING THE MATERIAL INTO THE BLADE, WHICH CAN BE HAZARDOUS.

ALWAYS WEAR SAFETY GOGGLES OR SOME TYPE OF EYE PROTECTION WHEN OPERATING MASONRY SAW.

CORRECT HEARING PROTECTION MUST ALSO BE WORN.

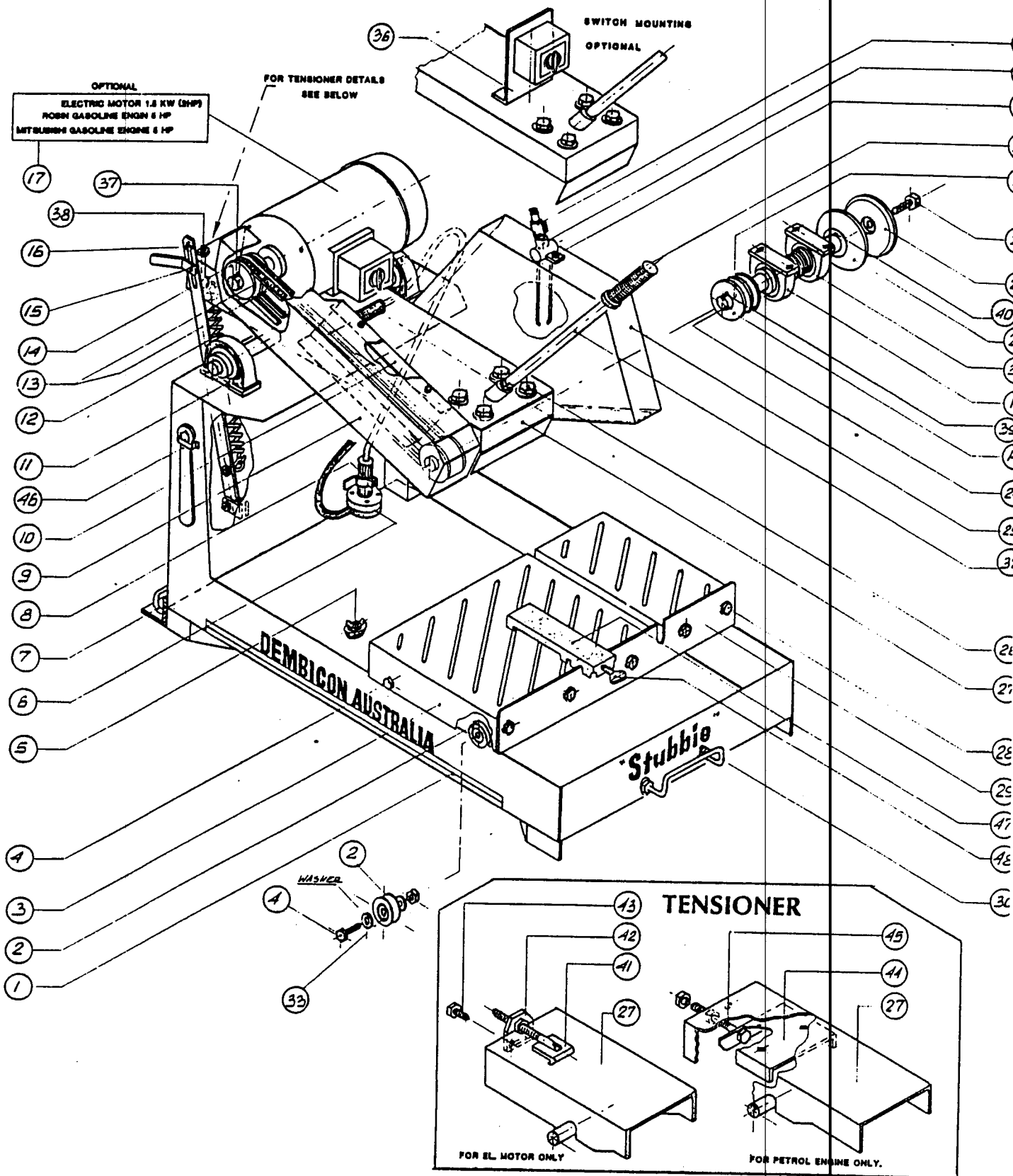

**STUBBIE I FIGURE 1**

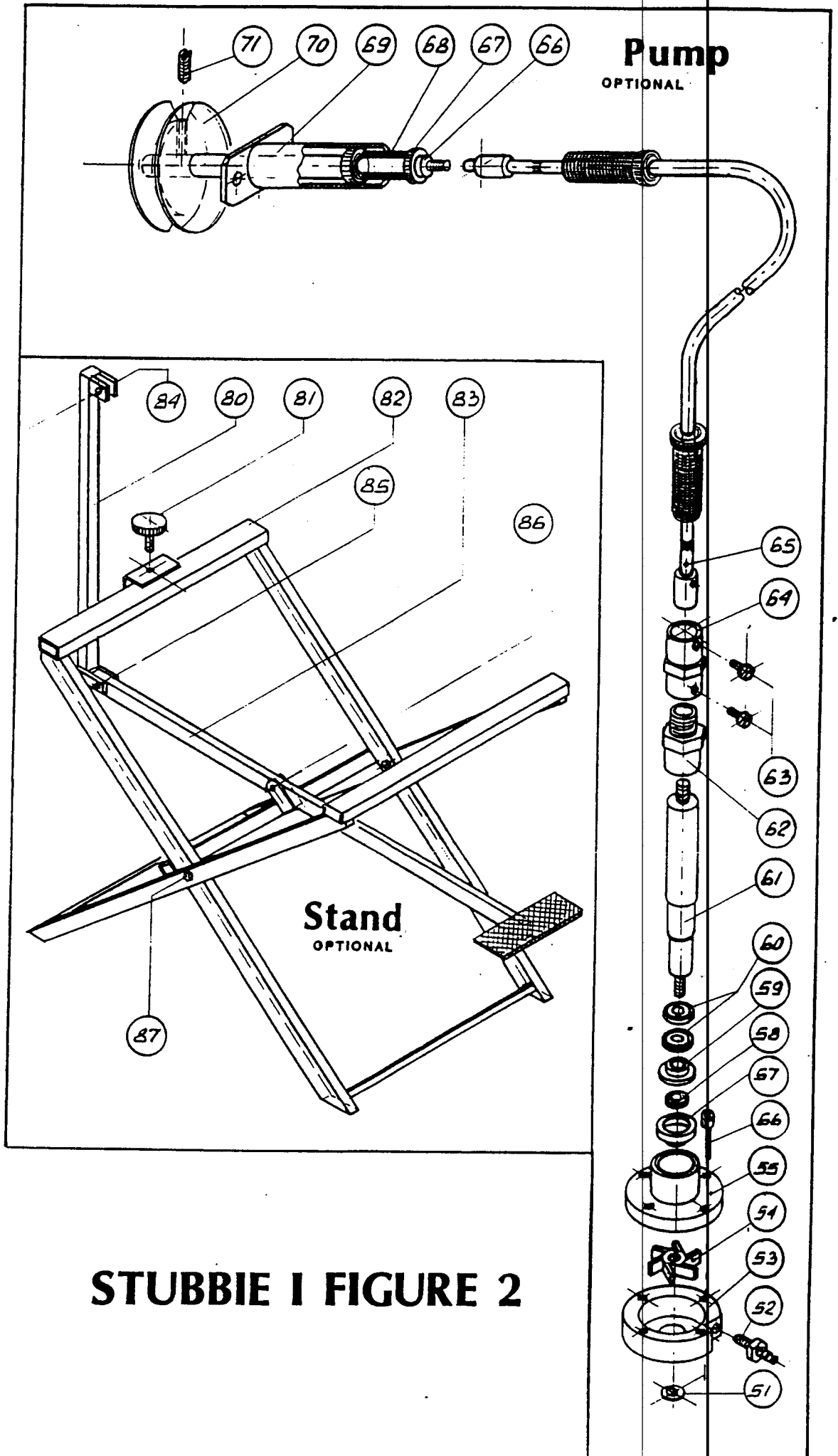

**STUBBIE I FIGURE 2**

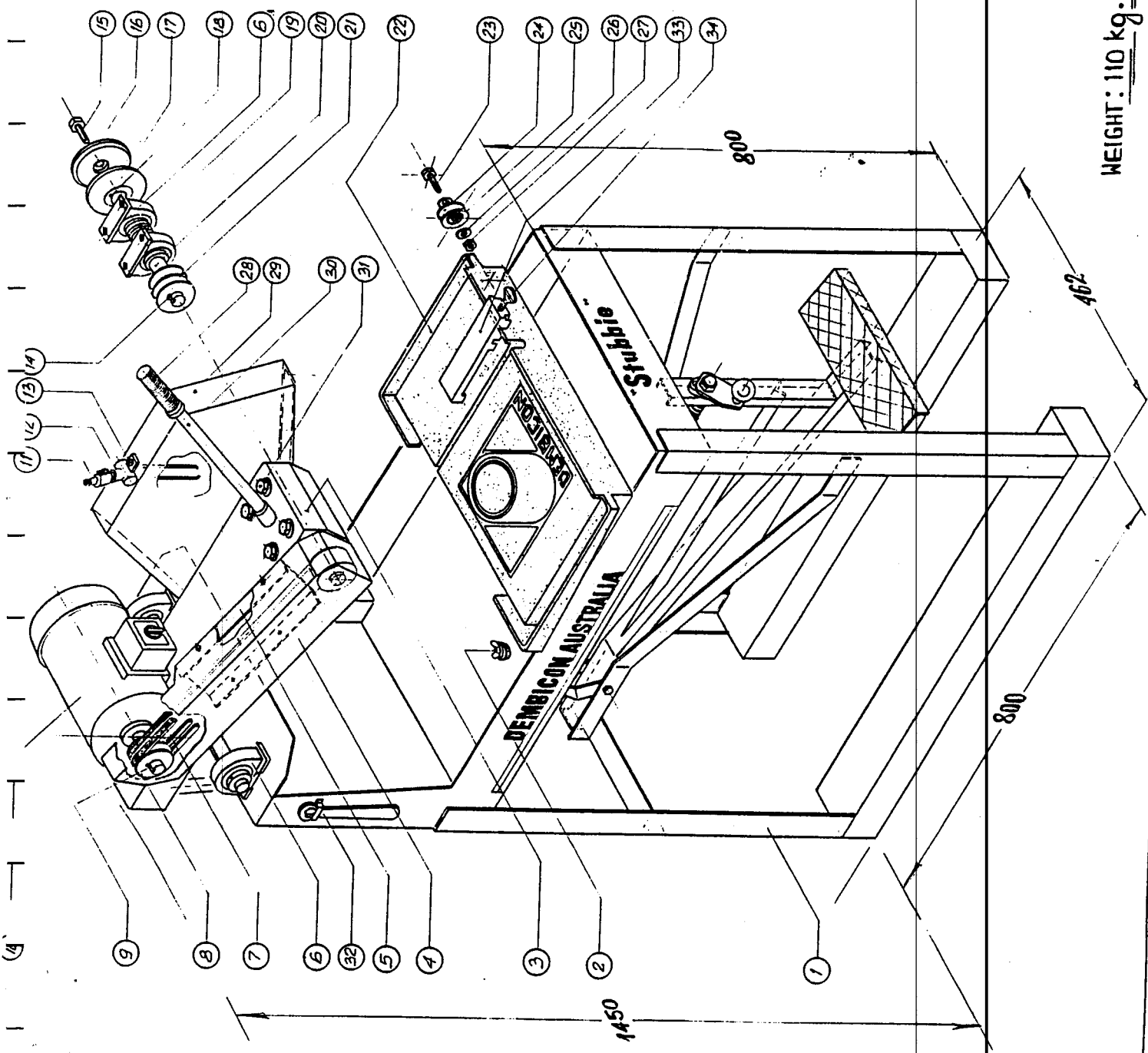

Dembicon Australia reserves the right to modify design

STUBBIE 2 **FIGURE 1**

WEIGHT: 110 kg.

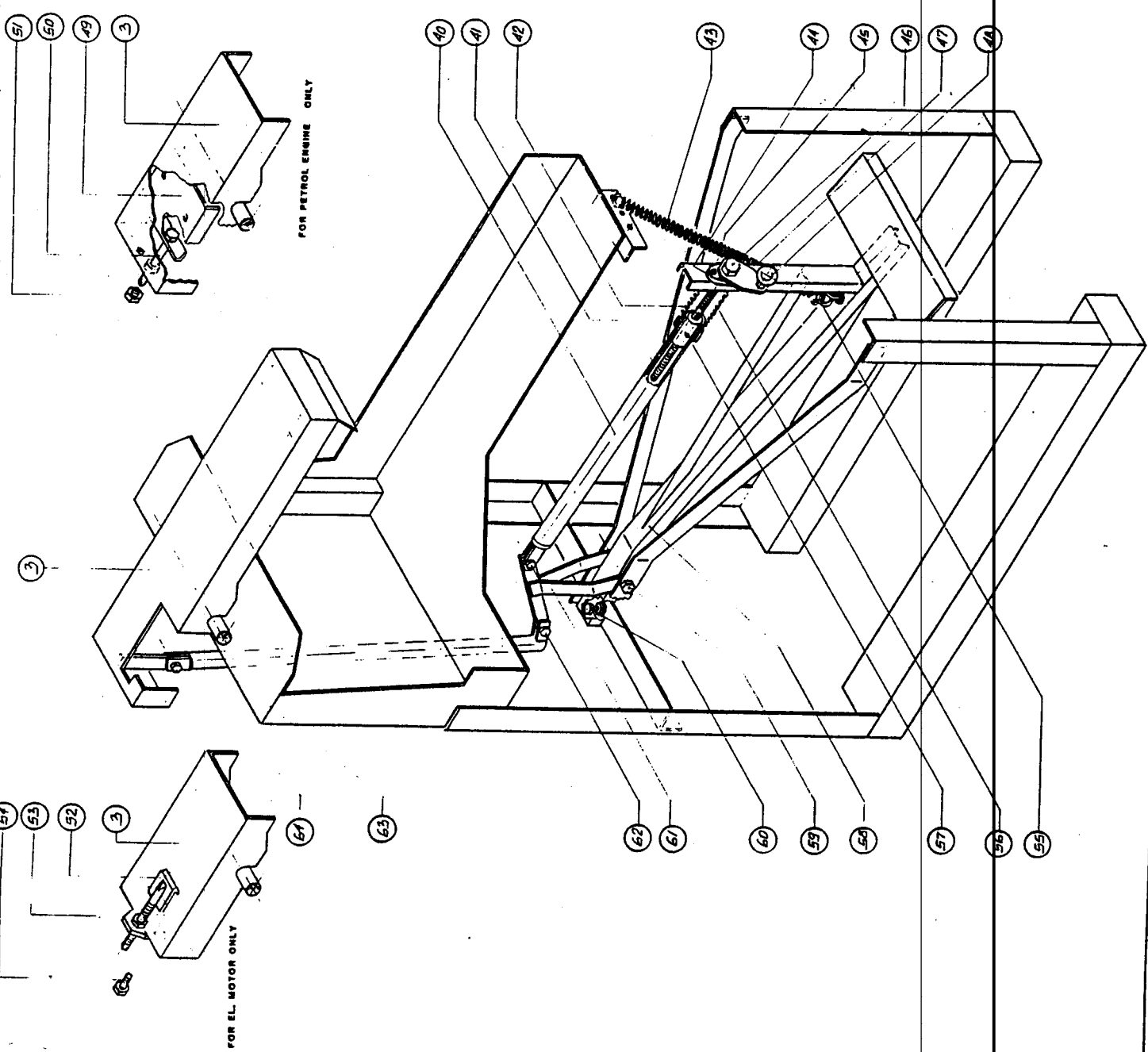

 <b>DEMIBICON AUSTRALIA</b> SUBSIDIARY DEMIBICO DOCS. INCORPORATED 10000 WILSON AVENUE WILSON AVENUE S.A. 5037 WILSON (ON 977 4227) (EST. 1988/87)		<b>STUBBIE 2<sup>1</sup></b>	DRAWING NUMBER <b>STB 2-FIG.2</b>
APPROVED CHECKED APPROVED SCALE	DATE 1988	DRAWING NUMBER STB 2-FIG.2	DRAWING NUMBER STB 2-FIG.2

The blade capacity  
of STUBBIE III -  
From 350mm(14")  
up to 500mm(20")

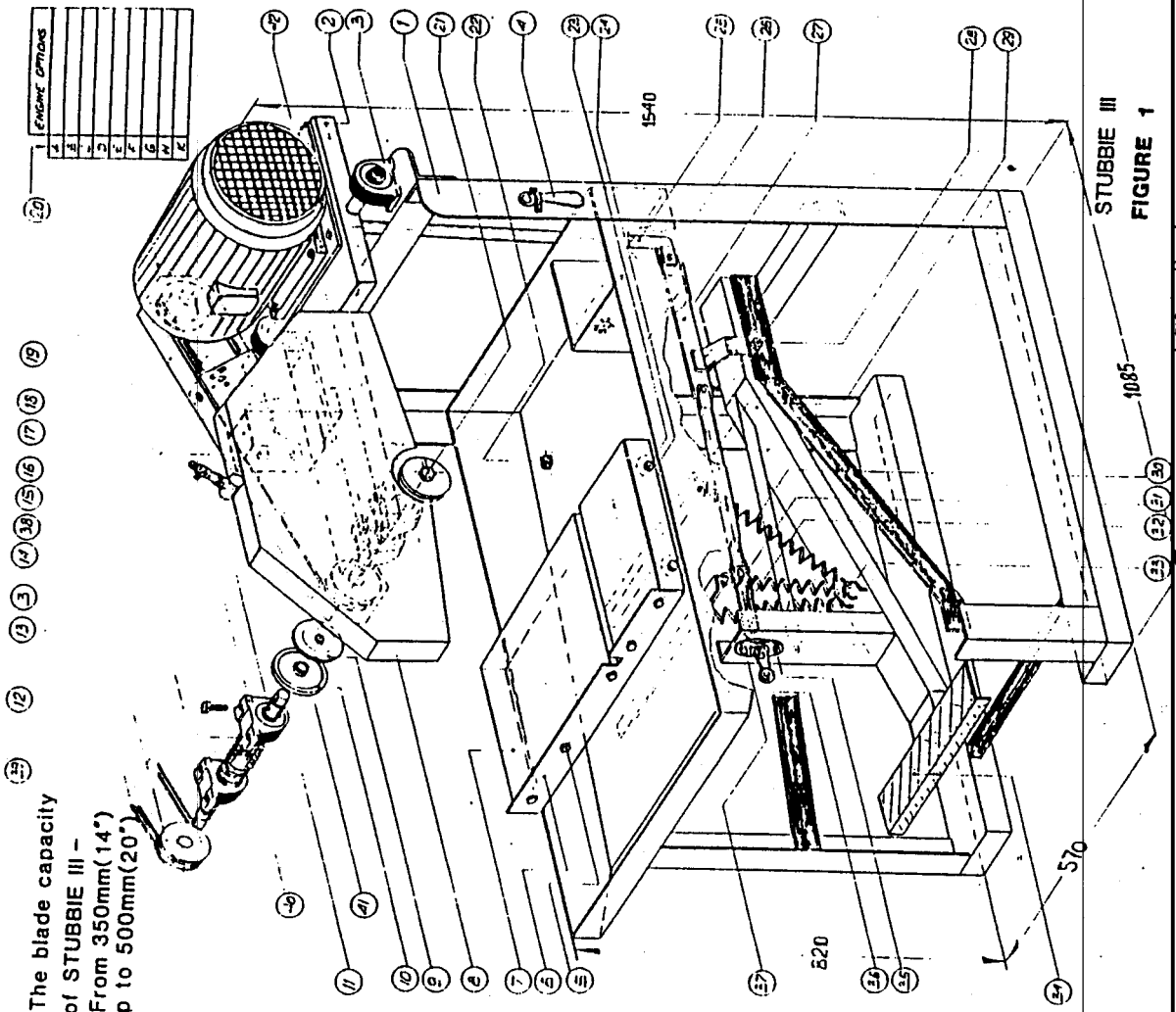

# STUBBIE 3. STB.3-FIG.1.

STUBBIE III  
FIGURE 1

WEIGHT : 200 KG. WITH 5.5 W. ELECTRIC MOTOR

THE INFORMATION IN THIS DOCUMENT IS UNCLASSIFIED  
DATE 08-11-2001 BY 60322 UCBAW/SJS/STP

# STUBBIE 1, 2 & 3 SPARE PARTS LIST

SSP1-B11-001 BUTTON RED ON OVERLOAD SWITCH  
SSP1-B11-002 OVERLOAD SWITCH  
SSP1-CC-B11 TOP CAPACITOR BCB - B11 MOTOR  
SSP1-CC-B11B BOTM CAPACITOR BCB - B11 MOTOR  
SSP1-CC-LRG CAPACITOR COVER - LARGE  
SSP1-CC-LRGBCB CAPACITOR COVER - LARGE - BCB  
SSP1-CC-LRGCMB CAPACITOR COVER - LARGE - CMG  
SSP1-CC-SML CAPACITOR COVER - SMALL  
SSP1-CC-SQ CAPACITOR COVER - SQUARE  
SSP1-CC-SQ-BCB CAPACITOR COVER - SQUARE - BCB  
SSP1-CC-SQ-CMG CAPACITOR COVER - CMG-80050406  
SSP1-CMG5064 BOTTOM CAPACITOR COVER CMG5064  
SSP1-CMG5065 TOP CAPACITOR COVER CMG5065  
SSP1-0500E BLADE SHAFT + FLNG/PULLEYS ELE  
SSP1-0500P BLADE SHAFT & FLGS/PULLEYS PET  
SSP1-0501 FAN COWLING  
SSP1-0501-BCB FAN COWLING BCB  
SSP1-0501-B11 FAN COWLING BCB - B11 MOTOR  
SSP1-0501-CMG FAN COWLING CMG  
SSP1-0502 CONVEYOR CART WHEEL COMPLETE  
SSP1-0502K CONVEYOR CART WHEEL-KIT OF 4  
SSP1-0503 CONVEYOR CART - COMPLETE  
SSP1-0504 5/16 X 3/8 X 5/8 C/CART BOLT  
SSP1-0505 DRAIN PLUG  
SSP1-0509 BELT GUARD OUTER  
SSP1-0510 BELT GUARD INNER  
SSP1-0511 BLADE SHAFT BEARING  
SSP1-0512 SPRING  
SSP1-0512-ST1 SPRING STUBBIE 1  
SSP1-0512-ST2 SPRING STUBBIE 2  
SSP1-0513-36 V BELT - ELECTRIC  
SSP1-0513-37 V BELT - PETROL  
SSP1-0513-39 V BELT - PETROL  
SSP1-0514 PULLEY SUIT MOTOR - ELECTRIC  
SSP1-0515 LOCKING LEVER  
SSP1-0517 PETROL ENGINE PULLEY  
SSP1-0518 TAP & FITTING  
SSP1-0519 WATER BAR + TAP  
SSP1-0521 BLADE SHAFT BOLT  
SSP1-0522 OUTER FLANGE  
SSP1-0523 INNER FLANGE  
SSP1-0524 BLADE SHAFT ONLY  
SSP1-0525 BLADE GUARD  
SSP1-0525-PET STUBBIE 1 PET. BLADE GUARD  
SSP1-0526 BOLT M10  
SSP1-0527 WELDMENT HEAD STUBBIE 1  
SSP1-0531 RUBBER HAND GRIP  
SSP1-0535 SHAFT COVER  
SSP1-0538 EYE BOLTS 5/16" BSW X 1.1/2"  
SSP1-0539 KEY  
SSP1-0540 KEY 3/16" X 3/16" X 3/8" LNG  
SSP1-0541 BELT ADJUSTER BRACKET  
SSP1-0542 BELT ADJUSTER, C/W NUT  
SSP1-0546 SPANNER  
SSP1-0547 MITRE GUIDE  
SSP1-0548 FAN 2HP BCB  
SSP1-0549 BACK BAR STUBBIE 1

SSP1-0550 RESET BUTTON 2HP BCB  
SSP1-0551 OVERLOAD, MOTOR, 2HP BCB  
SSP1-0552 START CAPACITOR 2HP BCB  
SSP1-0552-B11 START CAPACITOR  
SSP1-0553 RUBBER BOOT STUBBIE I, III  
SSP1-0554 SWITCH, ON-OFF 2HP BCB  
SSP1-0555 RUN CAPACITOR 2HP BCB 30 MF  
SSP1-0556 START CAPACITOR CMG BLUE 80 MF  
SSP1-0557 RUN CAPACITOR CMG LRGE 16 MF  
SSP1-0558 HANDLE FOR STUB I LOCK LEVERS  
SSP1-0559 MOTOR GUARD SUPPORT BRACKET  
SSP1-0560 HOUSING FOR BLADE SHFT BEARING  
SSP1-0561 FAN  
SSP1-0574 ENGINE PULLEY  
SSP1-0575 HOSE CONNECTOR CLIK-ON 1/2"  
SSP1-0576 MOTOR ELECTRIC STUBBIE 1 1.5KW  
SSP1-0577 HANDLE STUBBIE 1  
SSP1-0578 HARDENED RAILS SET OF 2  
SSP1-0579 TRAY STUBBIE 1  
SSP1-0580 WATER BAR C/W FITTING  
SSP1-0581 AIR FILTER 17210/ZE1/822  
SSP1-0583 HORIZONTAL LEVER  
SSP1-0584 BACK BAR  
SSP1-0585 DRIVE END, END SHIELD  
SSP1-0641 HOSE CLIP  
SSP2-0502K CONVEYOR CART WHEEL-KIT OF 4  
SSP2-0503A CONVEYOR CART  
SSP2-0512 RETURN SPRING  
SSP2-0643 SPRING SUIT FOOT PEDAL  
SSP2-0644 HEIGHT ADJUSTER BEARING  
SSP3-0001 SWITCH LIMIT HEAVY DUTY  
SSP3-0002 T/ROD, BRG & HOUSING WIND MECH  
SSP3-0003 ADJUSTER PLATE - ELECTRIC MTR  
SSP3-0500 BLADE SHAFT C/W FLANGES  
SSP3-0505 DRAIN PLUG  
SSP3-0511 BLADE SHAFT BEARING  
SSP3-0512 HOUSING FOR BLADE SHAFT BRKT  
SSP3-0521 BLADE SHAFT BOLT  
SSP3-0522 OUTER FLANGE  
SSP3-0523 INNER FLANGE  
SSP3-0524 BLADE SHAFT C/W INNER FLANGE  
SSP3-0542 BACKBAR STUBBIE III  
SSP3-0700 HEAD-COMPLETE  
SSP3-0701 CONVEYOR CART COMPLETE  
SSP3-0702 CONVEYOR CART WHEEL - COMPLETE  
SSP3-0717 BELT GUARD INNER  
SSP3-0718 BELT GUARD OUTER  
SSP3-0719 PULLEY MOTOR  
SSP3-0730 FOOT PEDAL SPRING  
SSP3-0737 FOOT PEDAL BEARING  
SSP3-0739 V-BELTS  
SSP3-0740 ON/OFF SWITCH CONTACTOR ONLY  
SSP3-0741 RELAY OVERLOAD  
SSP3-0742 OVERLOAD 3PH 4KW MTR  
SSP3-0743 MOTOR ADJUSTER  
SSP3-0744 COWLING ELECTRIC MOTOR 4KW  
SSP3-0745 FAN 4KW MOTOR