

600mm MANCOOLER FAN
PART No. - 200953
SCALE - 1 : 5

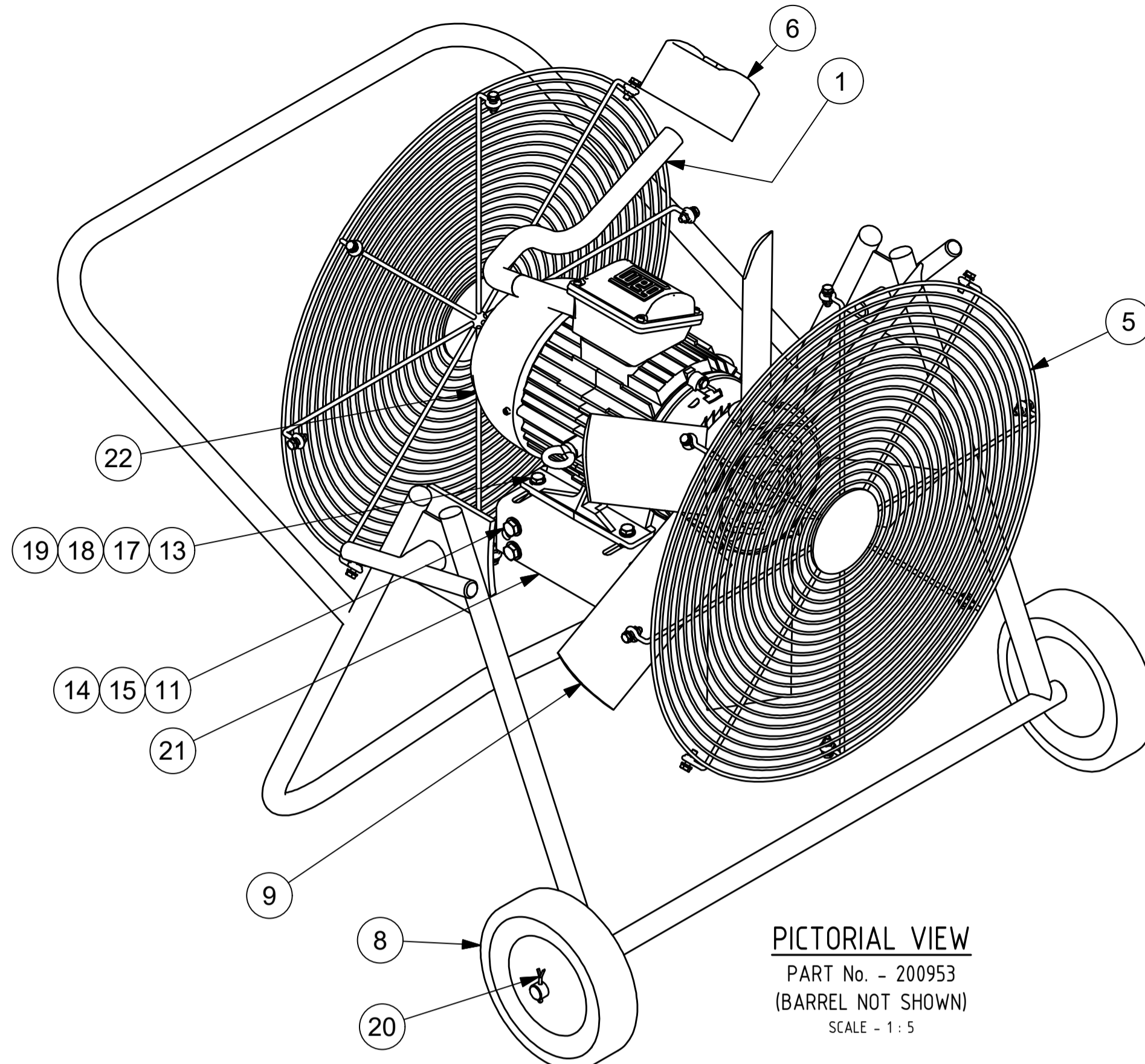

PICTORIAL VIEW
PART No. - 200953
(BARREL NOT SHOWN)
SCALE - 1 : 5

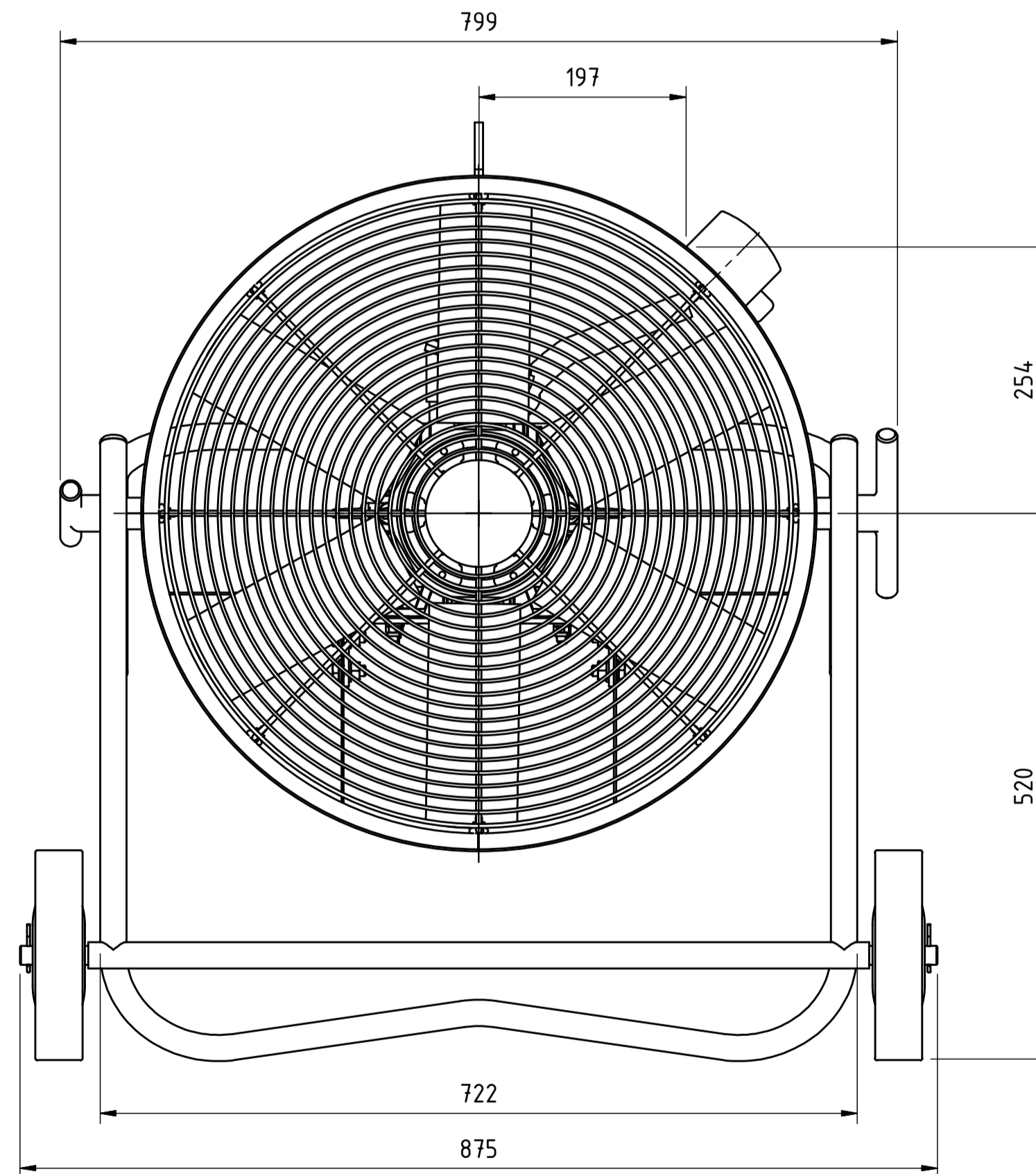

BILL OF MATERIALS - ASSEMBLY				
ITEM	QTY	PART NUMBER	DESCRIPTION	MASS
1	1	200953-CONDUIT	CONDUIT	0.4 kg
2	2	200965	T- HANDLE	1.7 kg
3	1	200967	600 MANCOOLER BARREL	31.3 kg
4	1	200980	MANCOOLER STAND	7.7 kg
5	2	200984	ASSEMBLY AND DETAILS	3.9 kg
6	1	500745	POWER ISO SWITCH	0.7 kg
7	4	500750	PLASTIC PLUG	0.0 kg
8	2	500770	Ø200 WHEEL	2.6 kg
9	1	IMP-G230-395GRP-12-28	IMPELLER, 1-61241	6.6 kg
10	16	ANSI B18.2.4.4M - M6 x 1	Metric Hex Flange Nuts	0.1 kg
11	8	AS 1110 - M10 x 25mm,	AS 1110 - BOLT,HEX,8.8CL	0.2 kg
12	16	AS 1110 - M6 x 20mm,ZINC	AS 1110 - BOLT,HEX,ZINC,8.8CL	0.1 kg
13	4	AS 1110 - M8 x 35mm,	AS 1110 - BOLT,HEX,8.8CL	0.1 kg
14	8	AS 1112 - M10,	AS 1112 - NUT,8.8CL	0.1 kg
15	16	AS 1237 - 10 mm,	AS 1237 - WASHER, FLAT,8.8CL	0.1 kg
16	16	AS 1237 - 6 mm, ZINC	AS 1237 - WASHER, FLAT,ZINC,8.8CL	0.0 kg
17	8	AS 1237 - 8 mm,	AS 1237 - WASHER, FLAT,8.8CL	0.0 kg
18	4	AS 1285 - M8,	AS 1285 - NUT, NYLOC,8.8CL	0.0 kg
19	4	AS 1968 -8mm,	AS 1968 - WASHER, SPRING,8.8CL	0.0 kg
20	2	ISO 1234 - 3.2 x 36	Split Pin	0.0 kg
21	1	MMMP-100-132F	Multi-Mount Motor Platform 100 to 132F	3.0 kg
22	1	14-ME002.241	2.2kW 1400RPM 240V ELECTRIC MOTOR	16.2 kg

TOTAL EST. WEIGHT = 75 kg (APPROX).
REFER TO MASTER BOM FOR OVERALL QTY

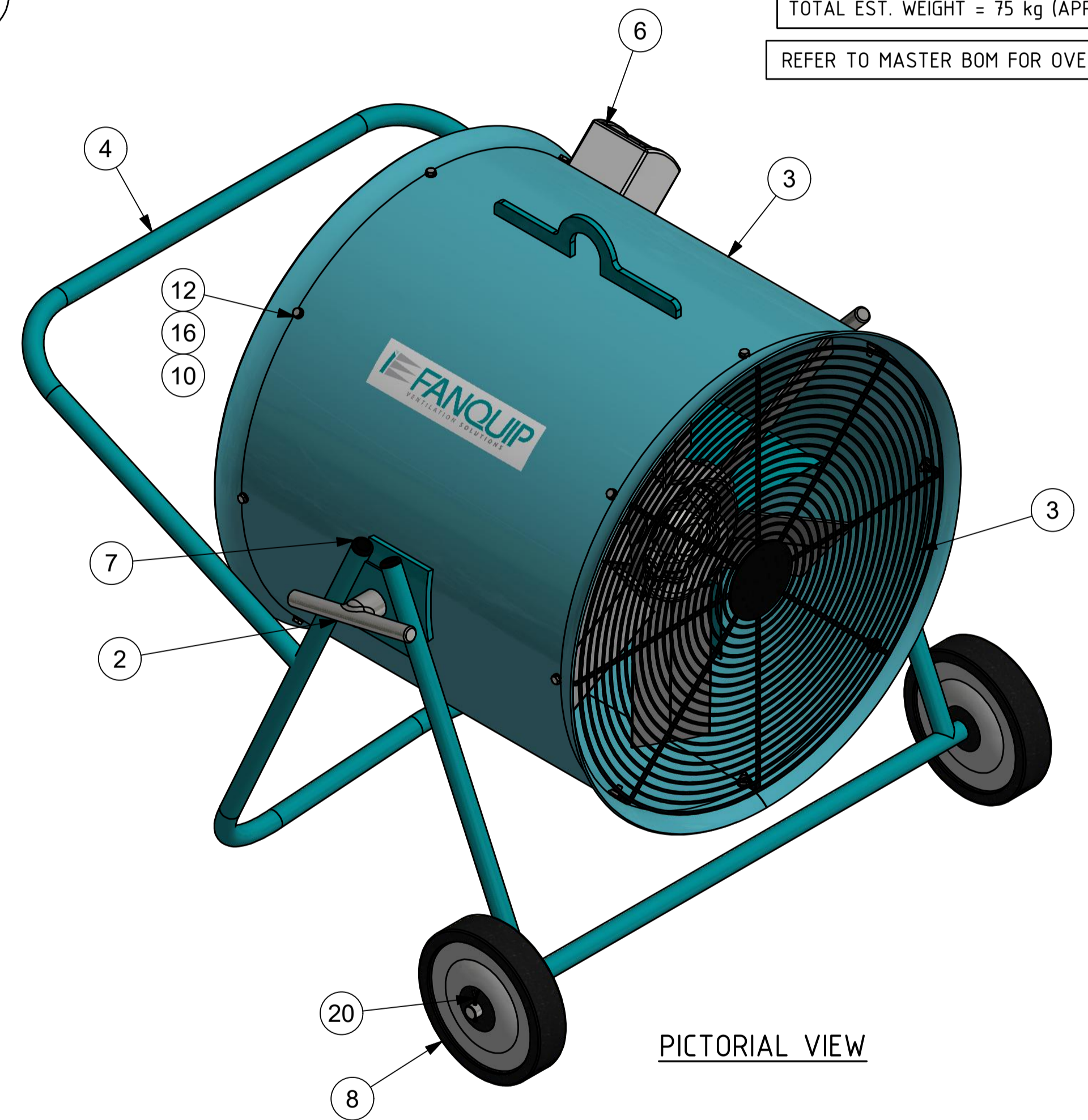

PICTORIAL VIEW

NOTES:
1. FOR STANDARD NOTES REFER TO DRAWING 107475

ISSUED FOR CONSTRUCTION

DRAWING NO.	REF DRAWING TITLE	REV	DATE	REVISION DESCRIPTION	DRAWN	ENGINEER	CHECKED	QA
1		0	11/07/2018	ISSUED FOR CONSTRUCTION	S.R.	R.B.	M.W.	



FANQUIP ABN 29 003 180 738 3 ROSELLA STREET SINGLETON NSW 2330 Ph: +61 2 6578 8600 Fax: +61 2 6578 8688 Web: www.fanquip.com.au				BY	DATE	SIGNED	TITLE
DRAWN	S.R.	11/07/2018		FANQUIP 600 MANCOOLER FAN - MODEL 1-61241 ARRANGEMENT			
ENGINEER	R.B.	11/07/2018					
CHECKED	M.W.	11/07/2018					
QA							

PROJECT NO.	DRAWING NO.	REVISION
	200953	0
PART NO.	CLIENT DRAWING NO.	SHEET
		1 / 1
SCALE:		A1

NOTE: THIS DRAWING IS SOLELY THE PROPERTY OF FANQUIP. THE INFORMATION IT CONTAINS IS NOT TO BE DISCLOSED, REPRODUCED OR COPIED IN WHOLE OR PART WITHOUT WRITTEN APPROVAL FROM FANQUIP.

